

Corso di *Architettura del XVII secolo in Italia*  
10.2) Bernini: S. Bibiana / S. Tommaso da Villanova / Assunzione  
di Ariccia / S. Andrea al Quirinale

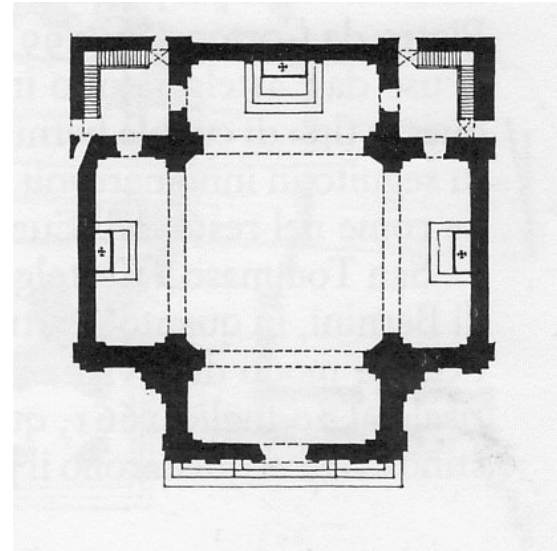

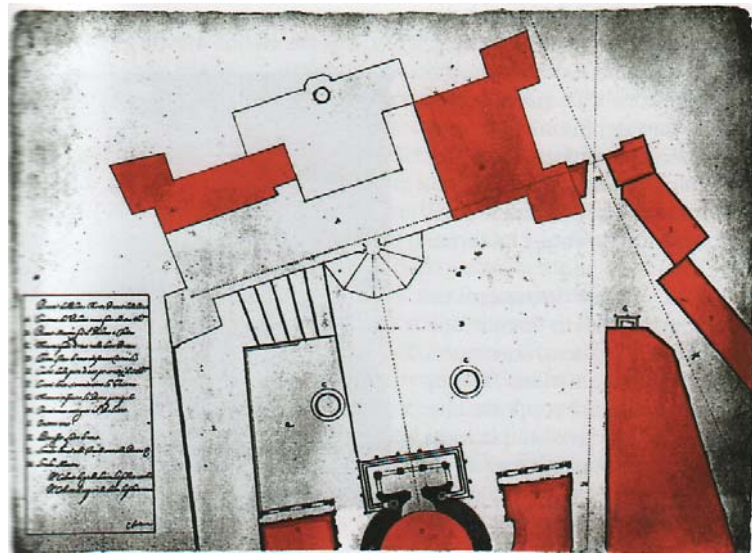

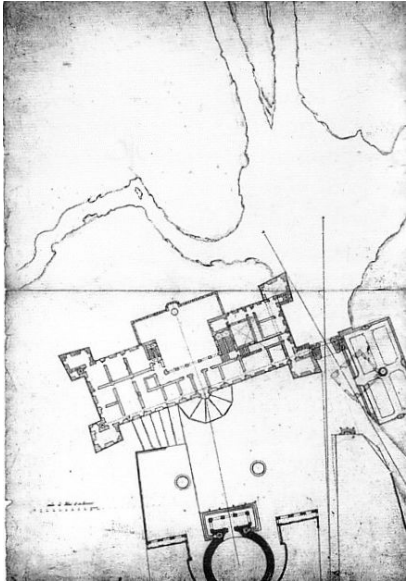



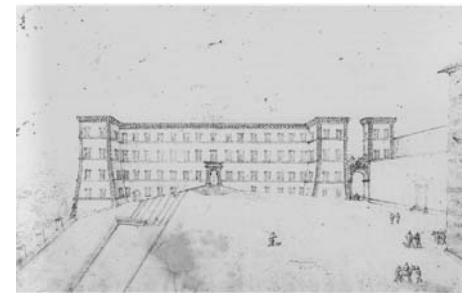
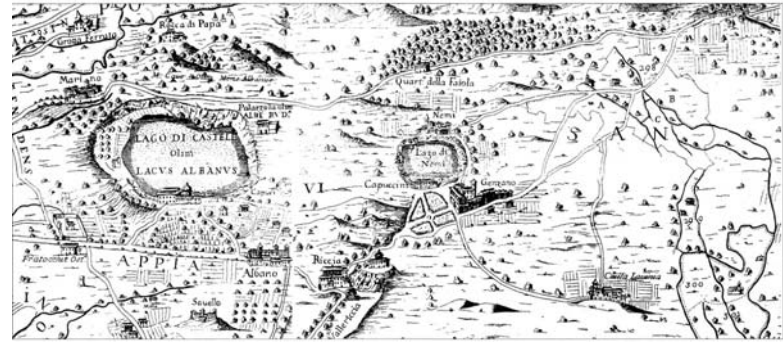

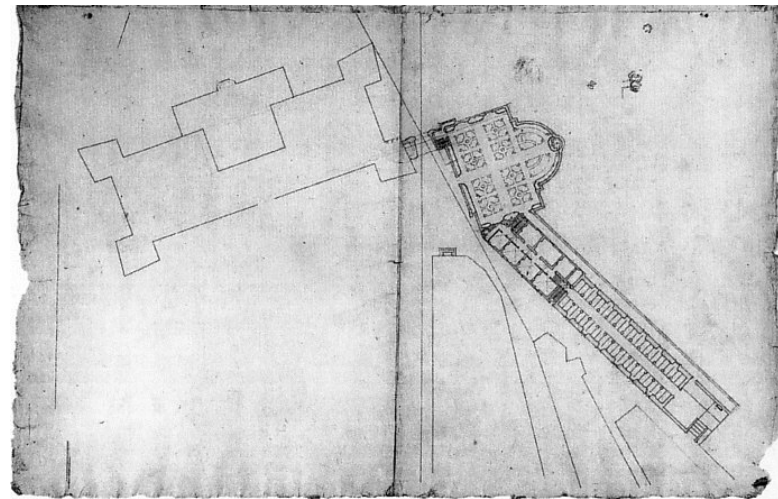
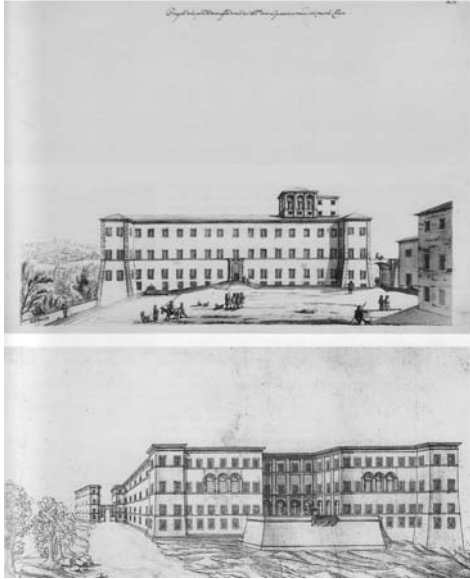

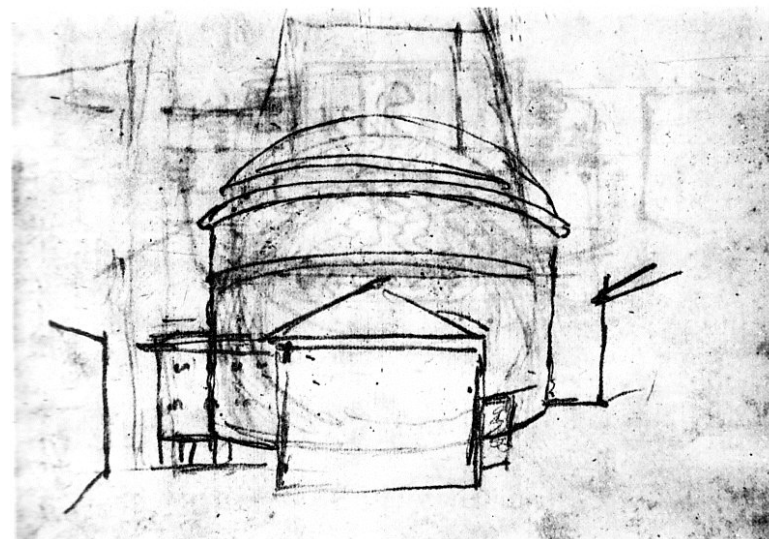

83. Progetto di restauro del Pantheon com'era in antico. Schizzo di G.L. Bernini, BAV, Clig., a I 19, c. 66r



La piazza della Rotonda verso il 1650. Disegno di Stefano Della Bella, Stockholm, Nationalmuseum

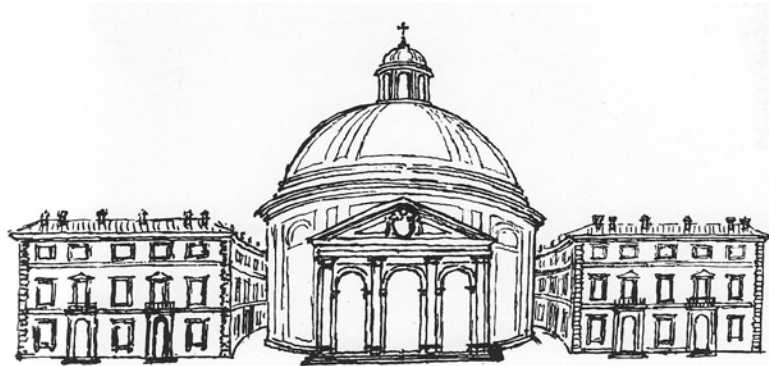
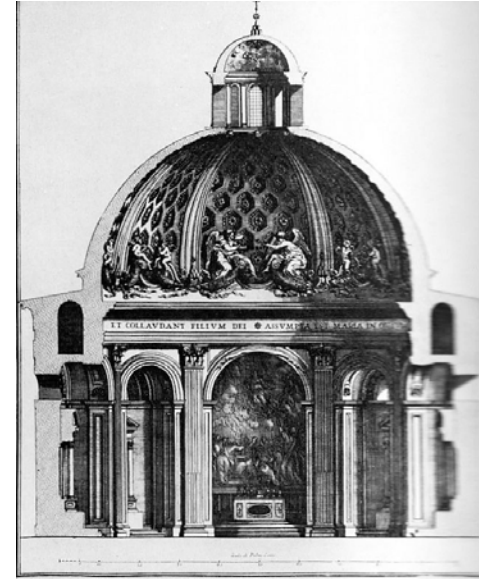

La piazza della Rotonda regolarizzata, con la casa dei canonici ricostruita e le colonne del portico restaurate. Incisione di G.B. Falda (II)

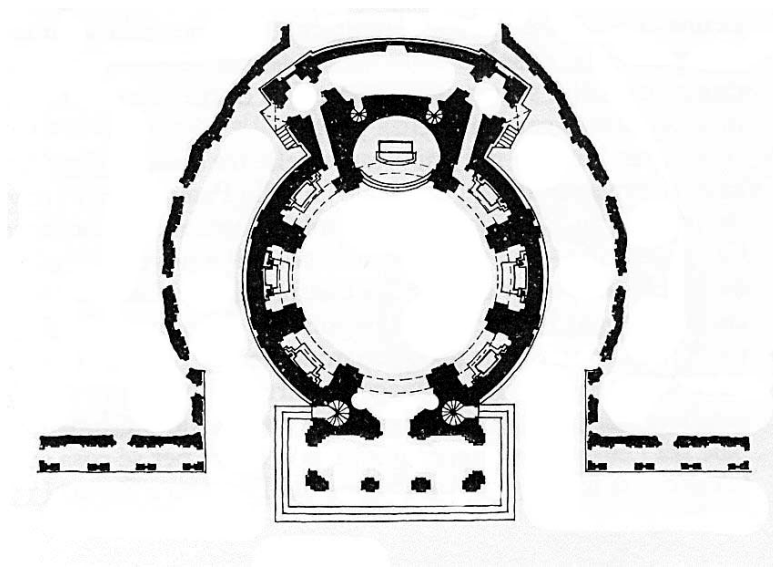
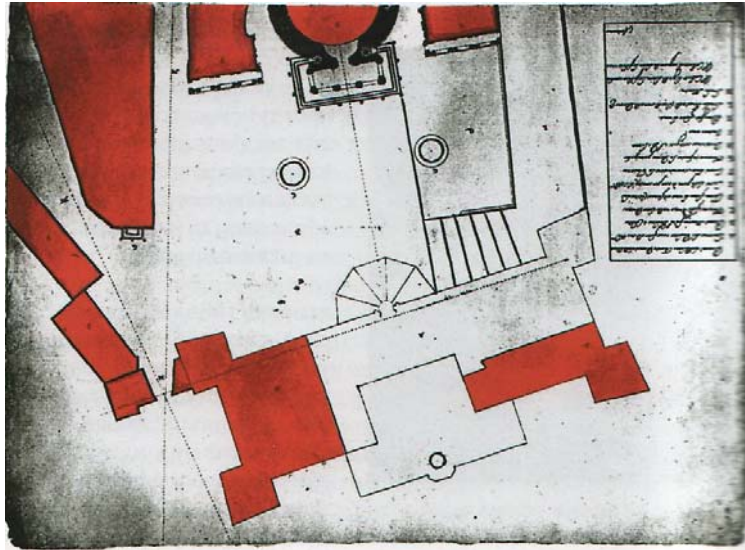

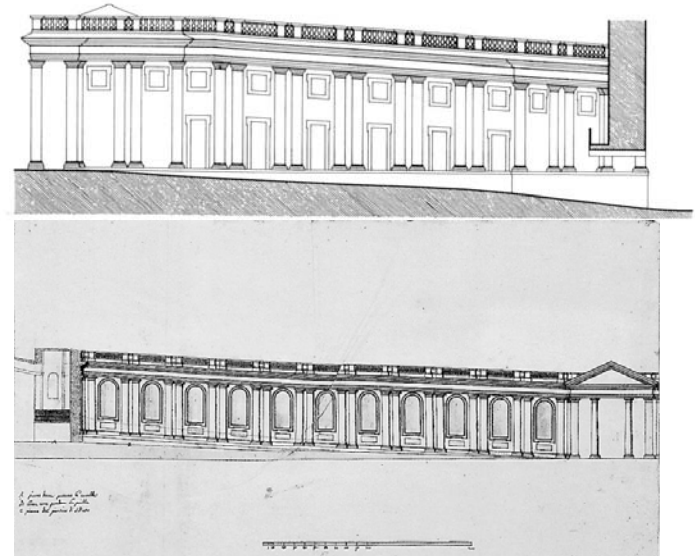
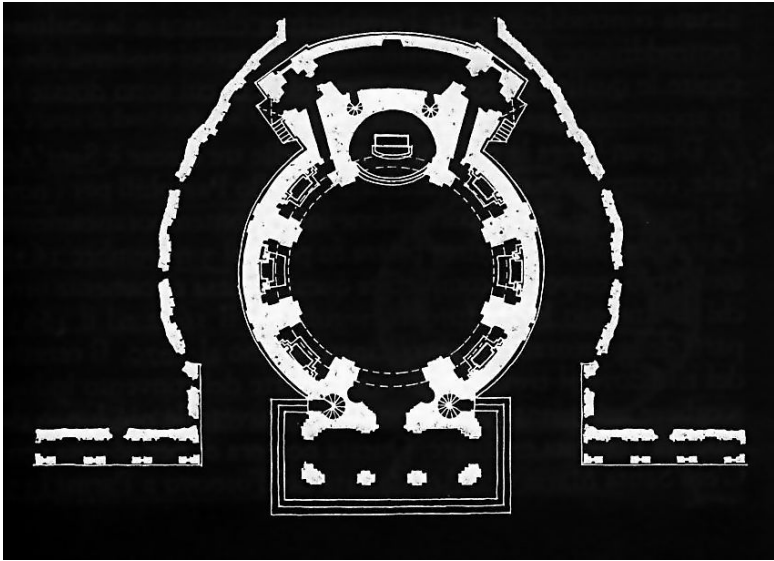
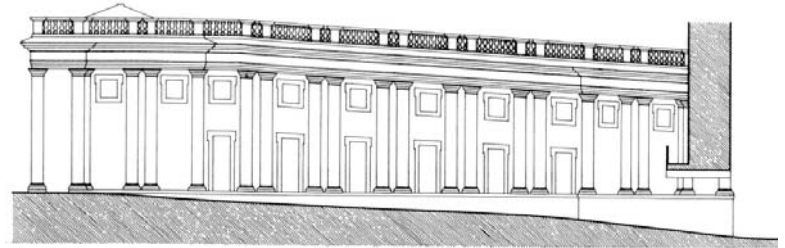

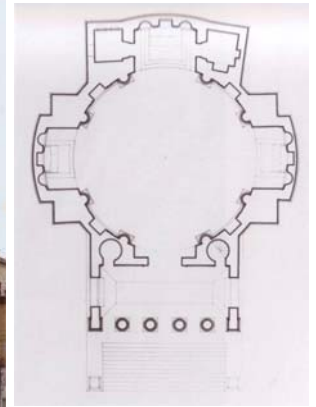
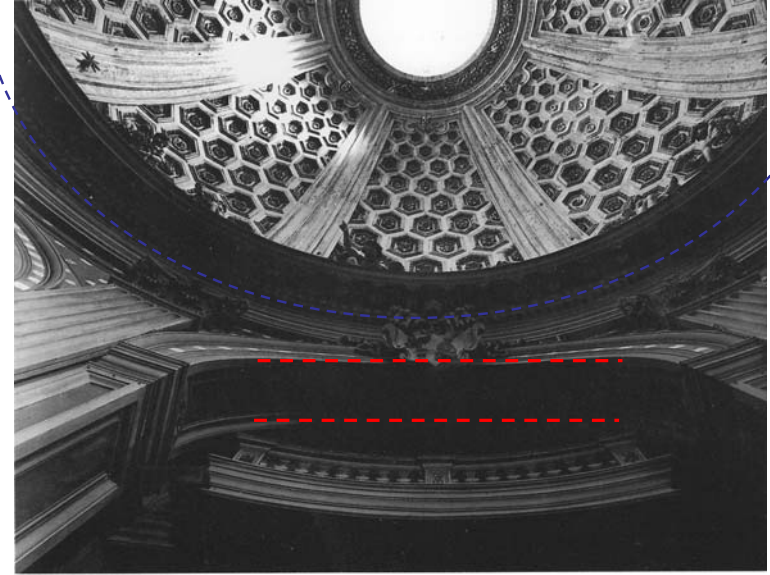
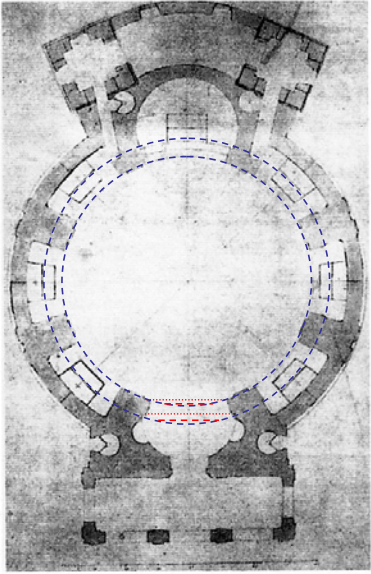

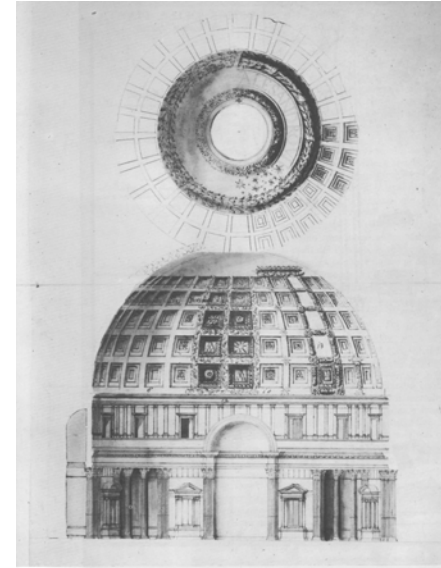
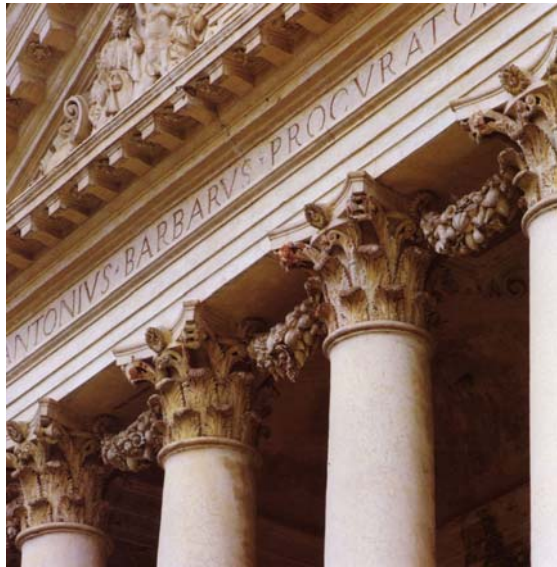

Progetto per decorare l'interno del Pantheon con gli ornati disegnati e nel nome di Alessandro VII. Disegno di G. Fontana.

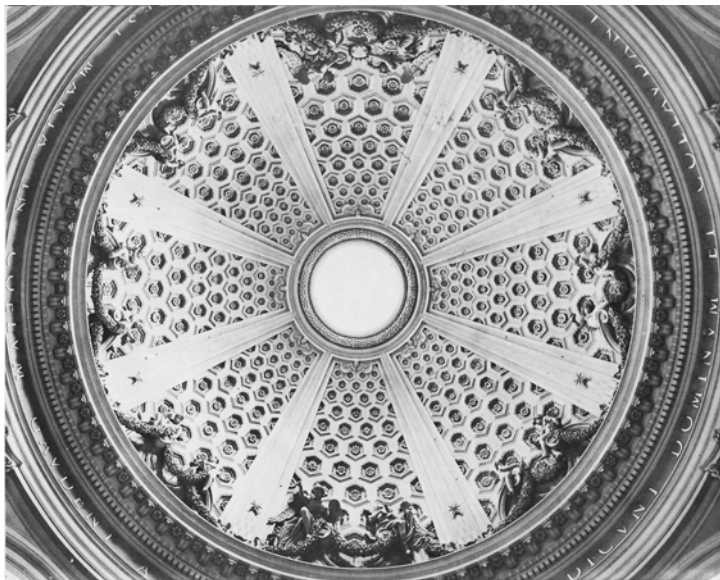

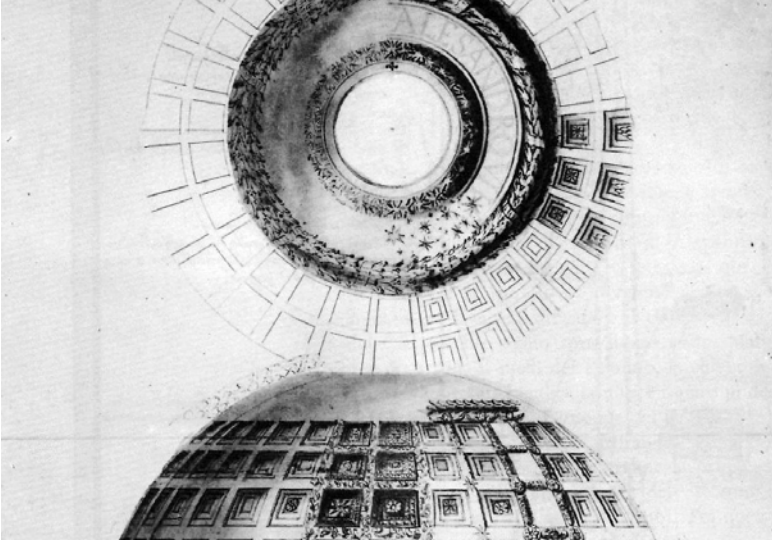
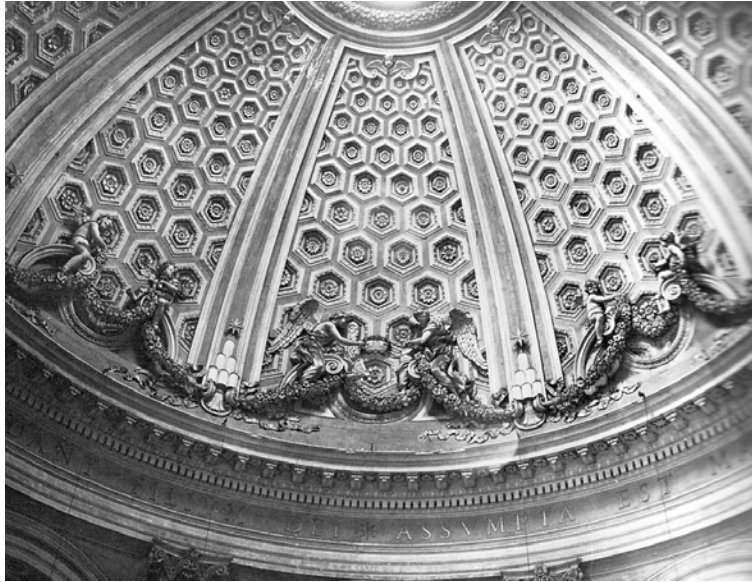

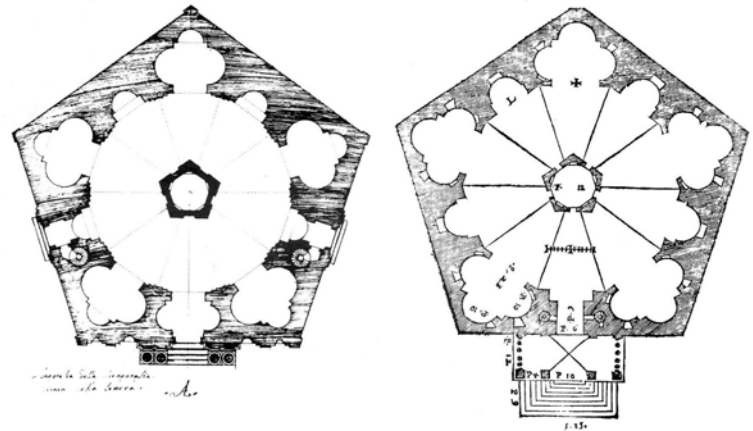
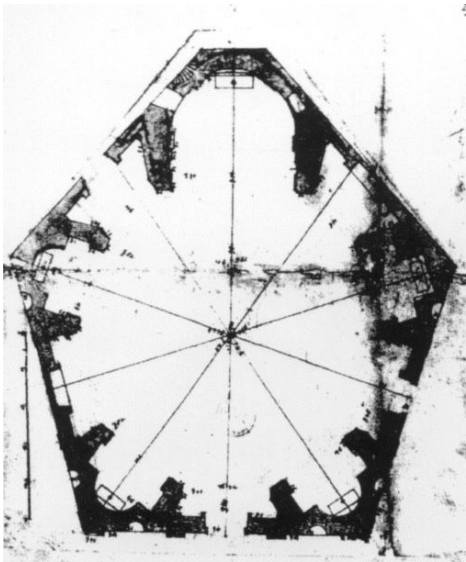
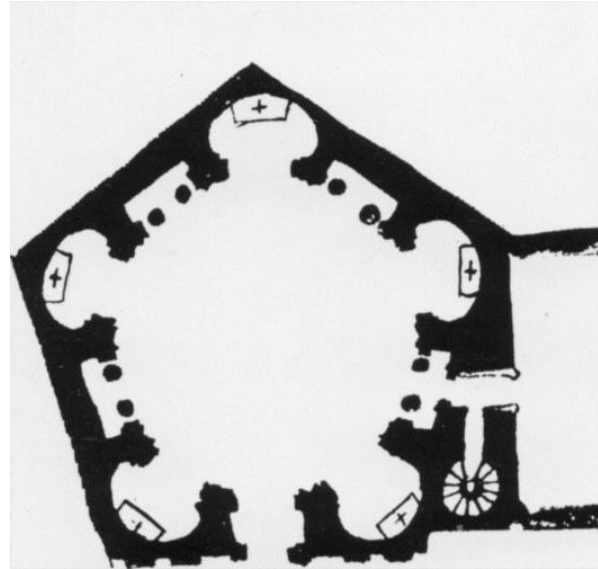

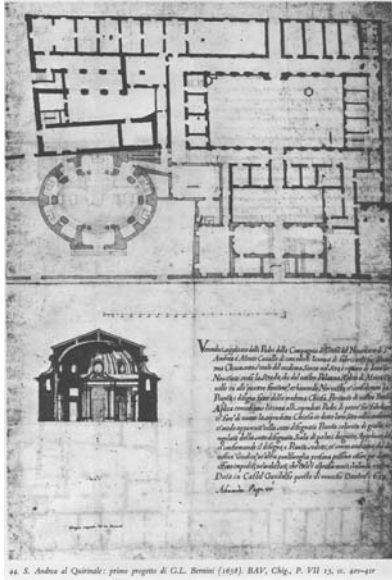

44. S. Andrea al Quirinale: primo progetto di G.L. Bernini (1631). BAV, Chig., P. VII 13, n. 47v-48r

