

Corso di *Architettura del XVII secolo in Italia*
10.3) Bernini, architettura civile: palazzi Ludovisi-Montecitorio,
Chigi-Odescalchi / Louvre / Monterano

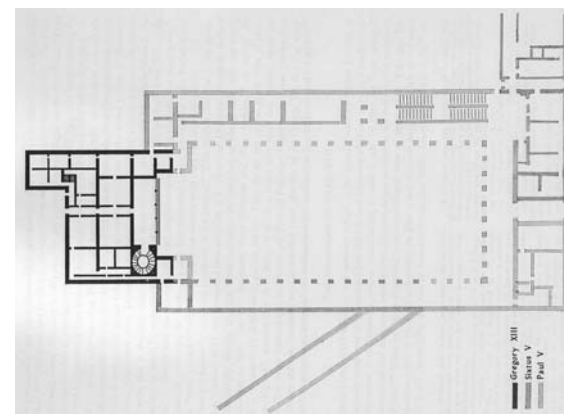

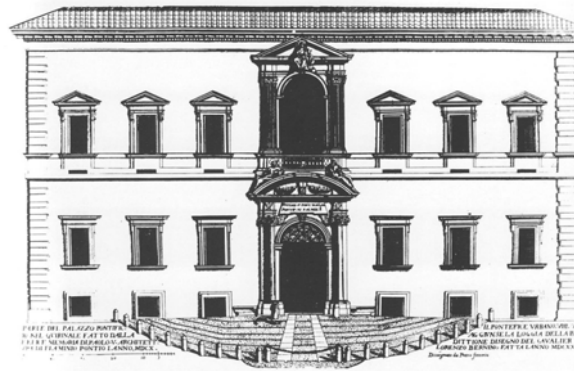

IL PALAZZO PAPALE, à nome Casale, nominato de S. S. Papa Paolo V. Sisto.
 18. Greuter, View of Quirinal Palace, 1618. Engraving, Biblioteca Nazionale Vittorio Emanuele



PAESE DEL PALAZZO PAPALE
 19. Anonymous view of Quirinal Palace, ca. 1644. Rome, Vatican Library

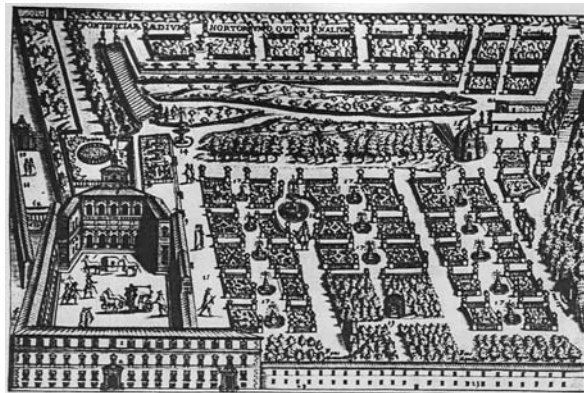

19. Quirinal Palace, Anonymous view, 1618. Milan, Castello Sforzesco, Collezione Bertorelli, Albo D 27, pl. 32

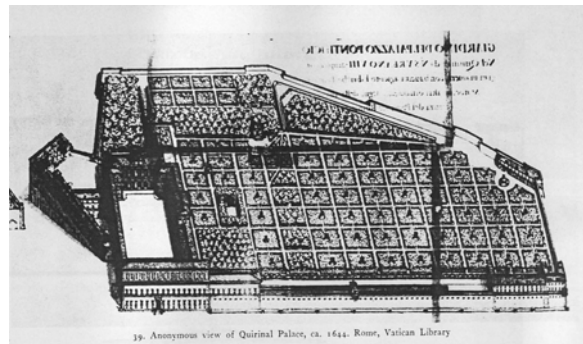

19. Anonymous view of Quirinal Palace, ca. 1644. Rome, Vatican Library

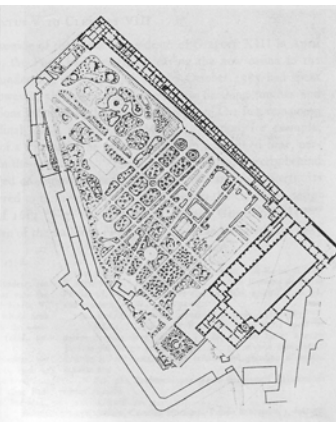

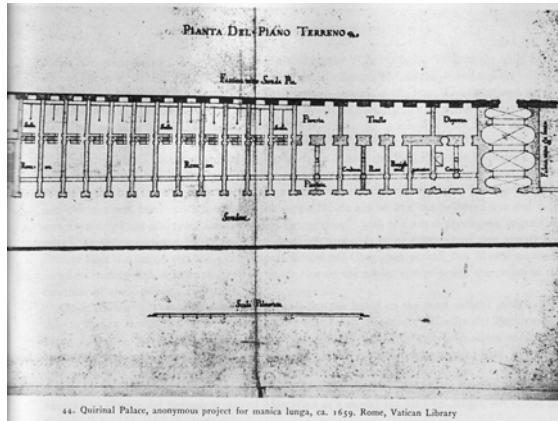

44. Quirinal Palace, anonymous project for manica lunga, ca. 1659. Rome, Vatican Library





11. Piazza Colonna e l'incompiuto palazzo Ludovisi a Montecitorio. Incisione di G.T. Vergelli (Le Fontane pubbliche delle piazze di Roma moderna, Roma 1890, tav. 9)



