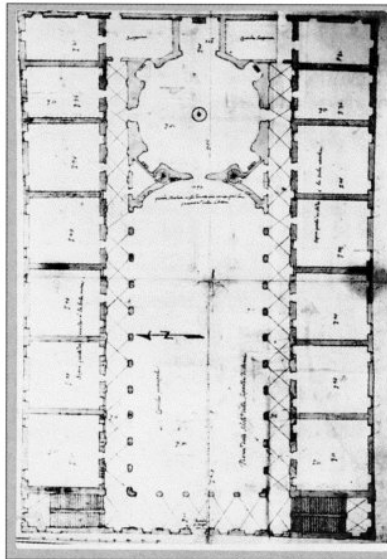
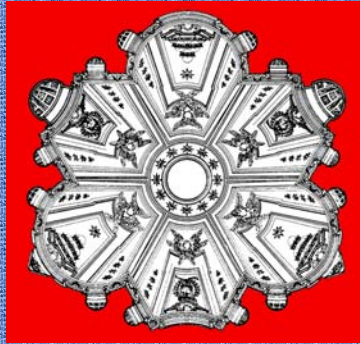
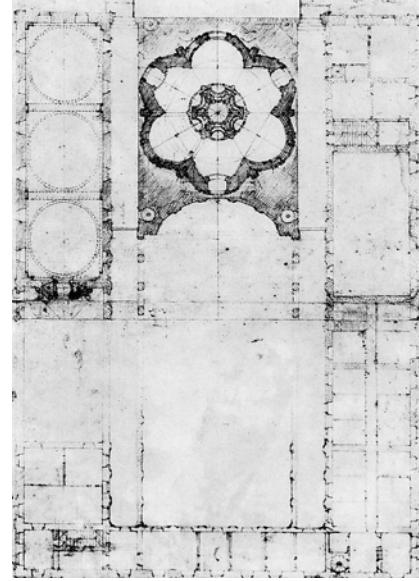
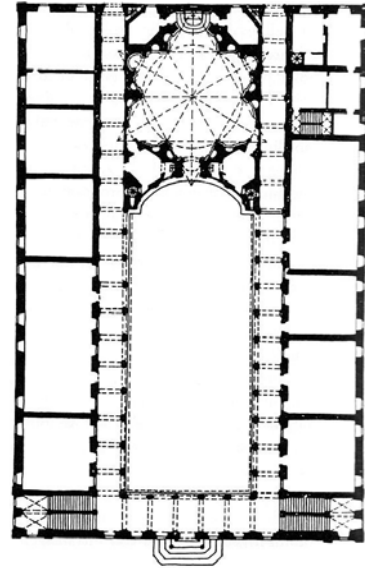
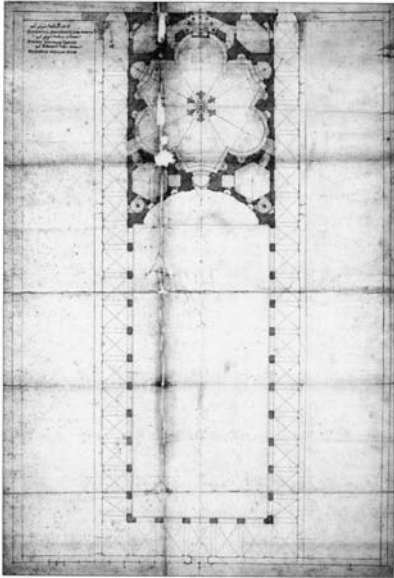


Corso di *Architettura del XVII secolo in Italia*
11.3) Francesco Borromini: S. Ivo alla Sapienza







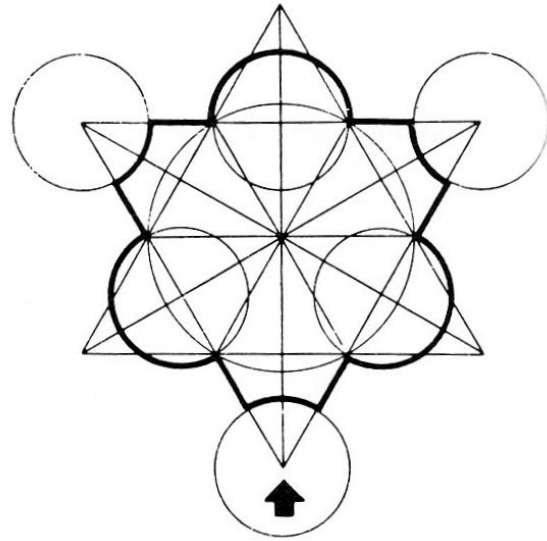
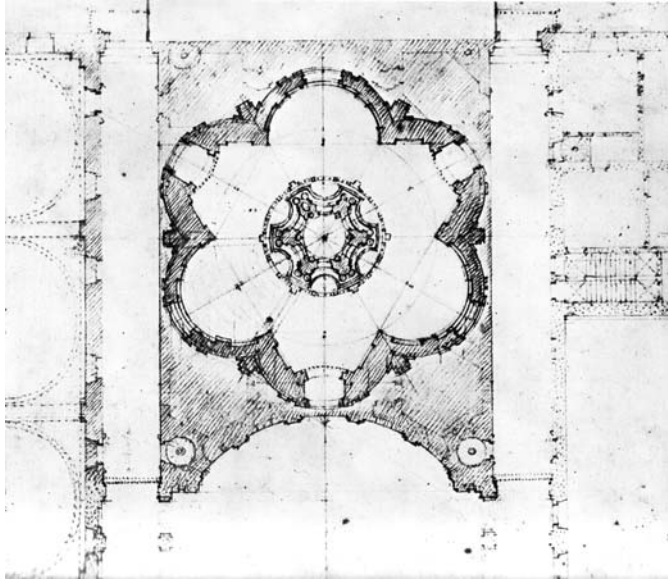
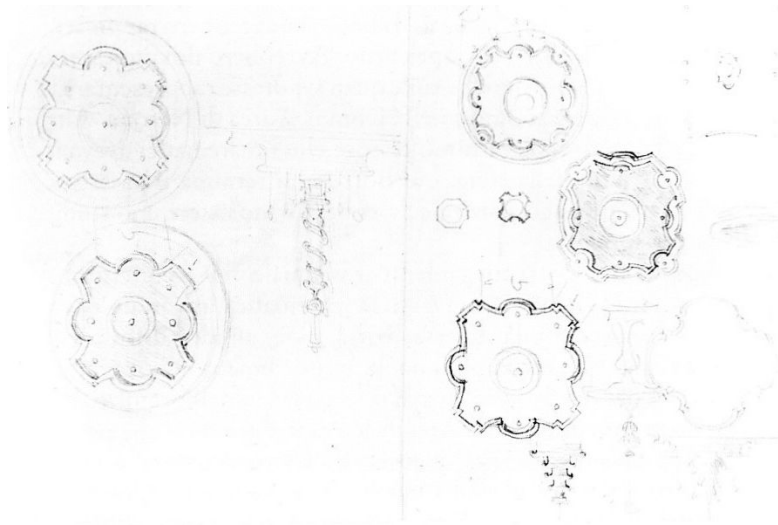


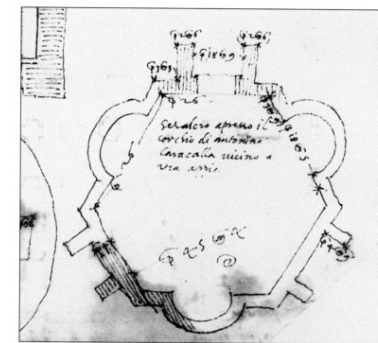
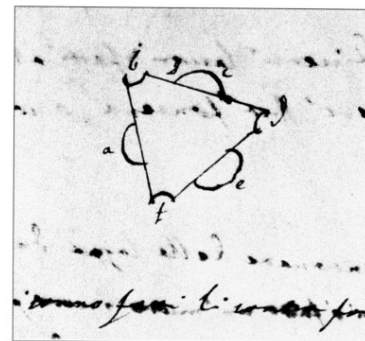
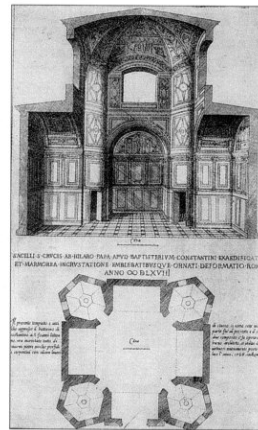
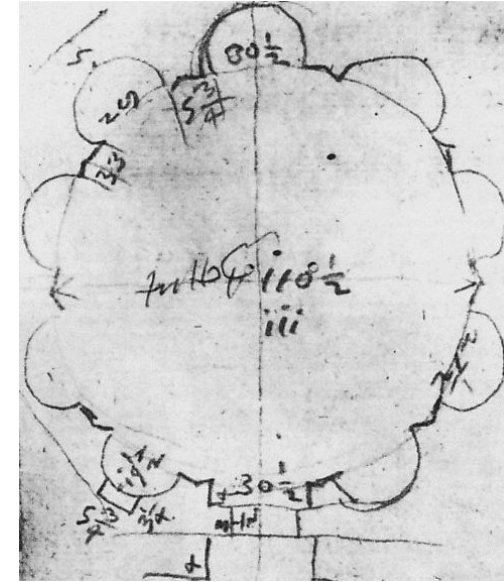
Fig. 1 - Firenze, Museo Nazionale. Formella presentata da Ghiberti al concorso per la porta del Battistero nel 1402.

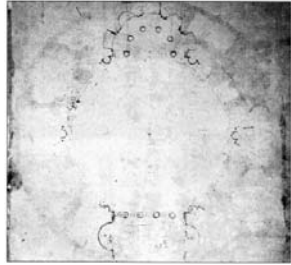
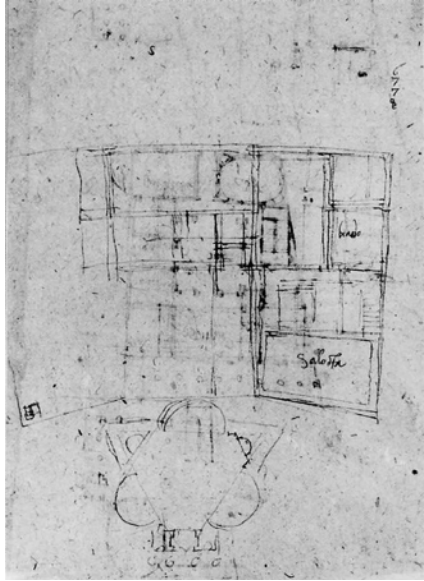


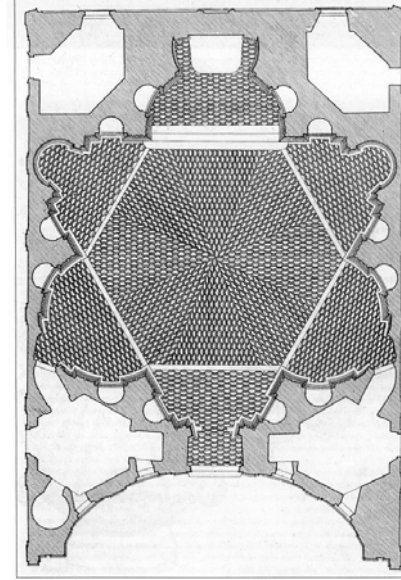
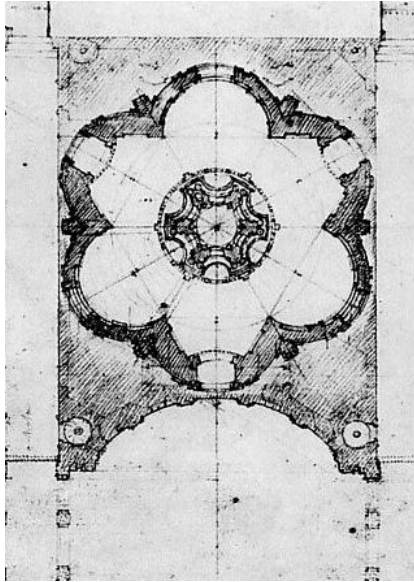
Fig. 2 - Firenze, Museo Nazionale. Formella presentata da Brunelleschi al medesimo concorso.

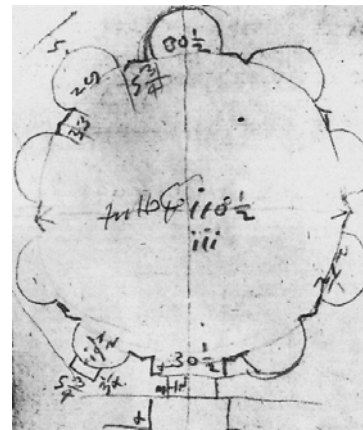
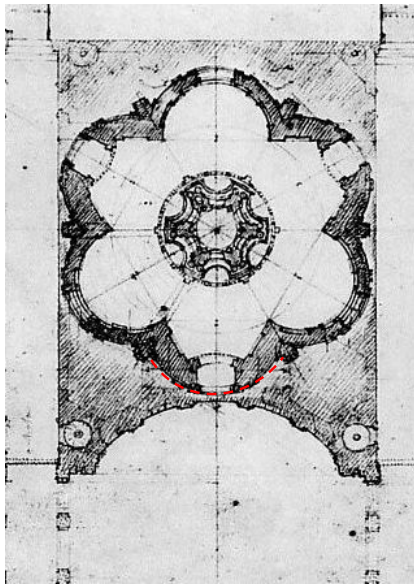


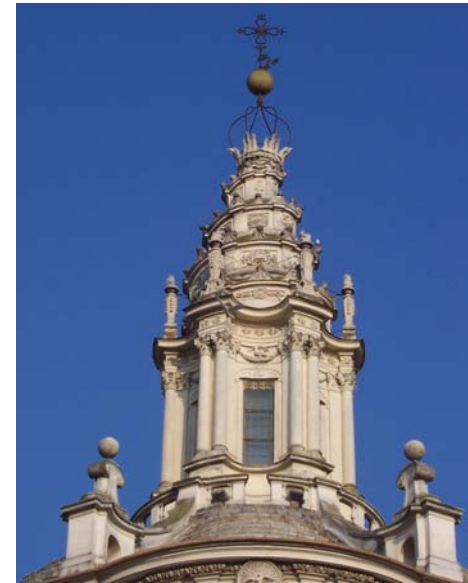
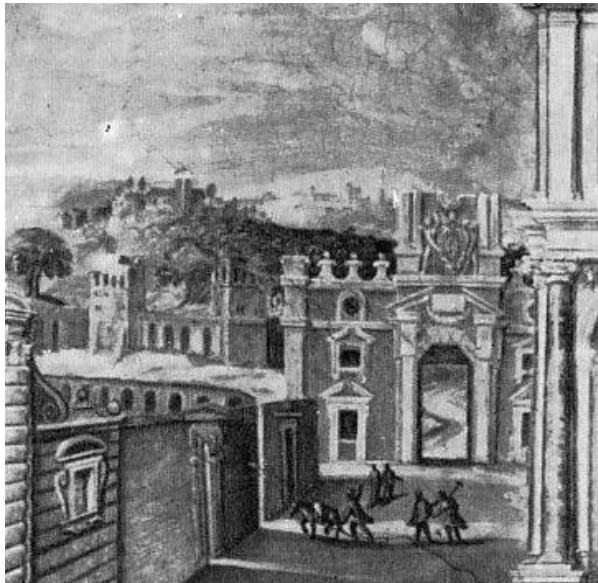
40. Borromini, disegni per una fontana per l'oratorio di San Filippo Neri, Roma.





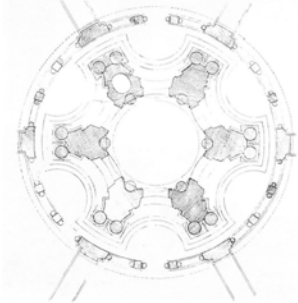




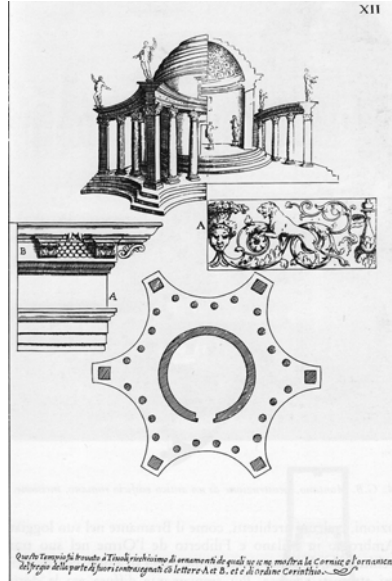




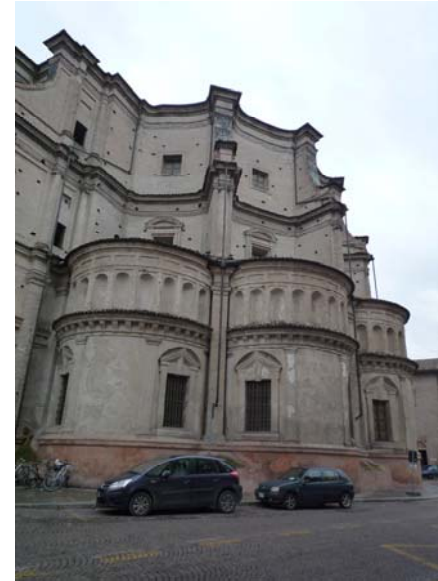
29. Tempio di Venere, Baalbek.

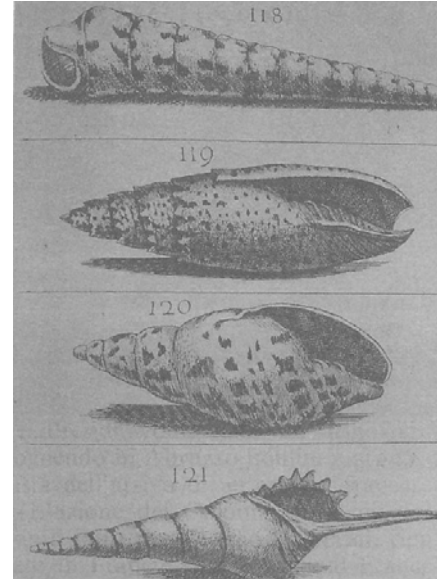
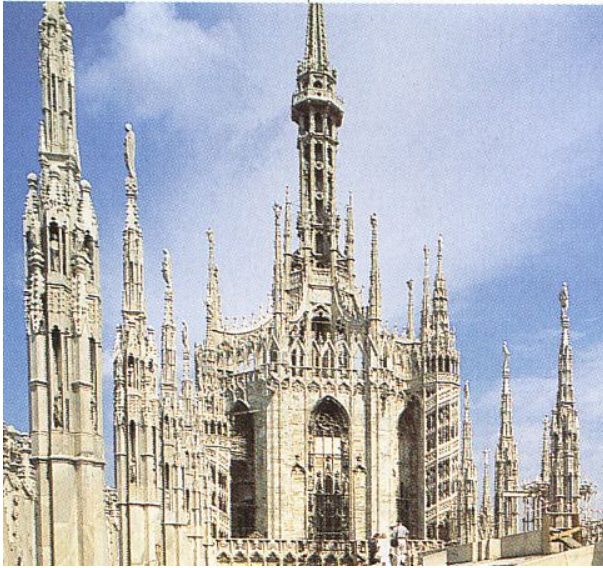


30. Borromini, Sant'Ivo della Sapienza, pianta della lanterna, incisione.

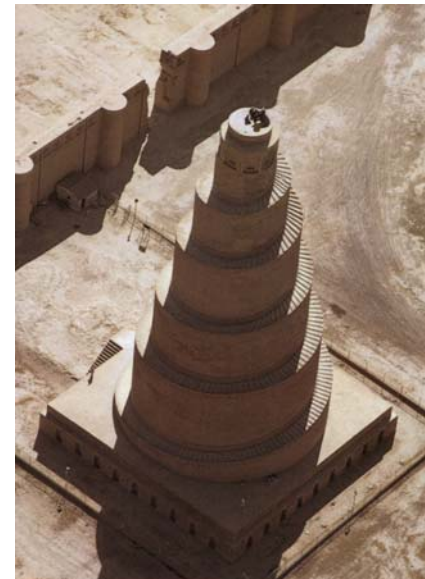


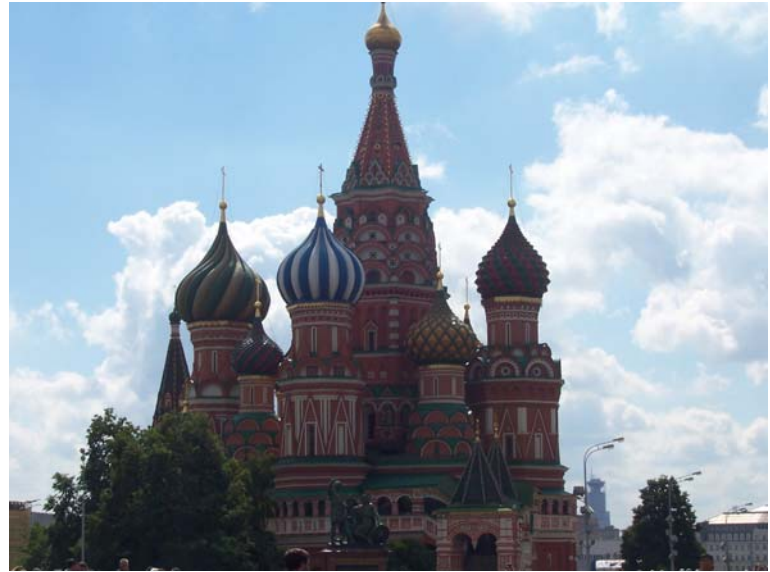
Questo Tempio si branta il Tivoli, e in questo di ornamenti de quali se ne mostra la Cornice e l'ornamento del fregio della porta di fuori con disegno di lettere A. et B. et c. di ordine Corintio.





5) Mitra Papalis ed altre tipologie di conchiglie spiraliformi da F. Buonanni, Ricreazione dell'occhio e della mente nell'Osservatione delle Chiocciolle proposta a' curiosi delle opere di Natura da P.F. Buonanni della Compagnia di Gesù, Roma 1681 (tav. 190)

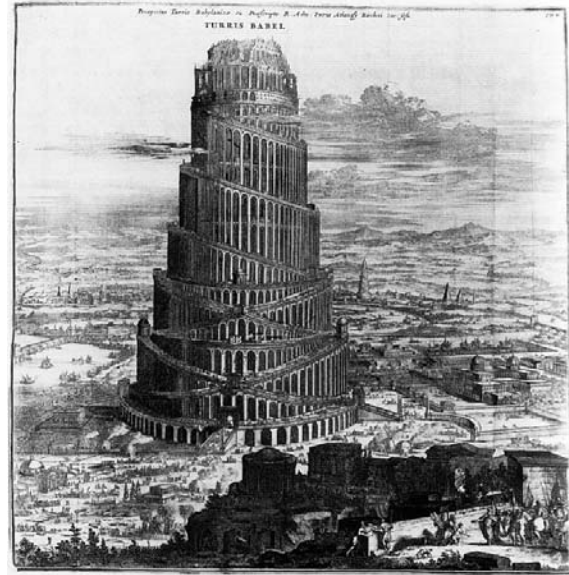




2) Maarten van Heemskerck e Philippe Galle, Il faro di Alessandria, incisione (1572)



JJ. Maarten van Heemskerck e Philippe Galle, Le mura di Babilonia e i giardini di Semiramide, incisione (1572)





4) Incisione raffigurante una pagoda, da A. Kircher, China Illustrata, Amsterdam, 1667

