

Corso di *Architettura del XVII secolo in Italia*
11.3) Francesco Borromini: L'Oratorio

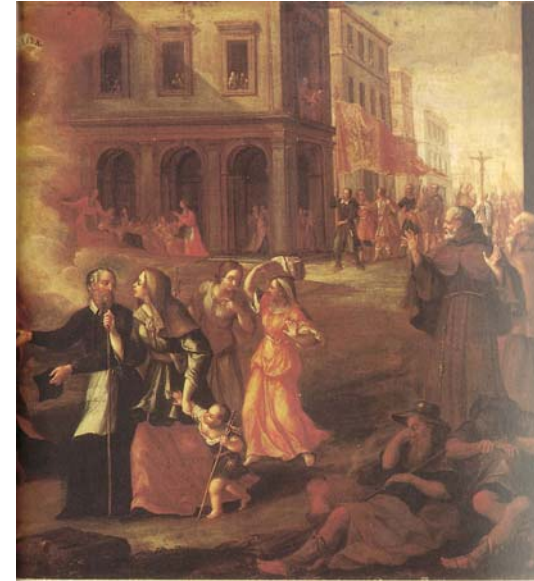

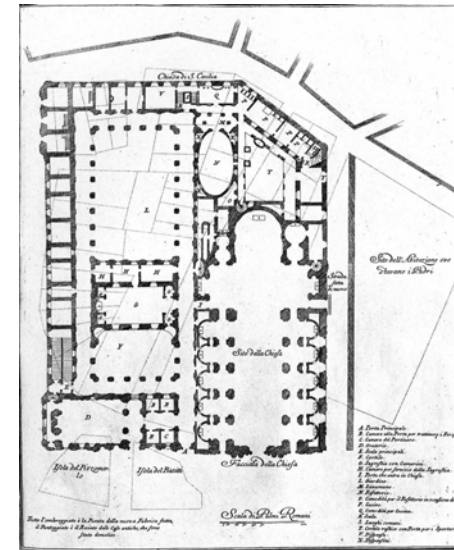

TAV. II

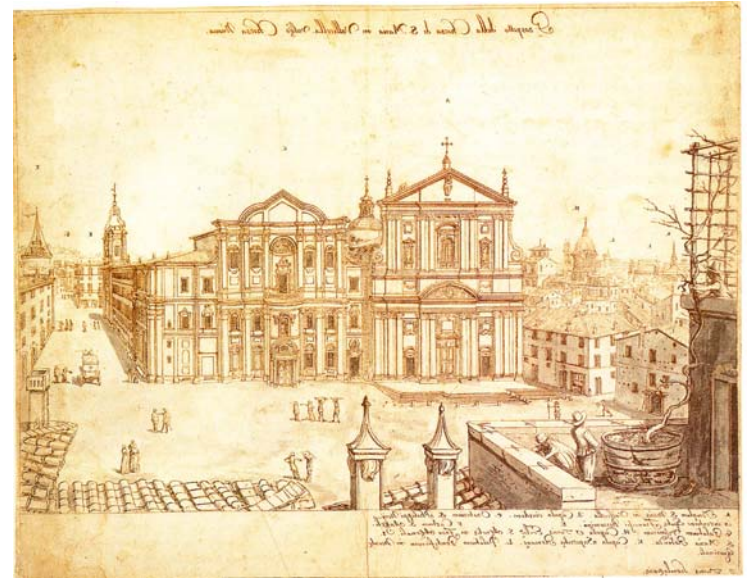
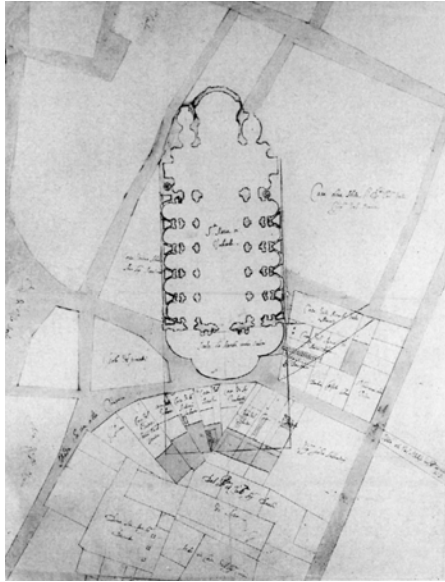
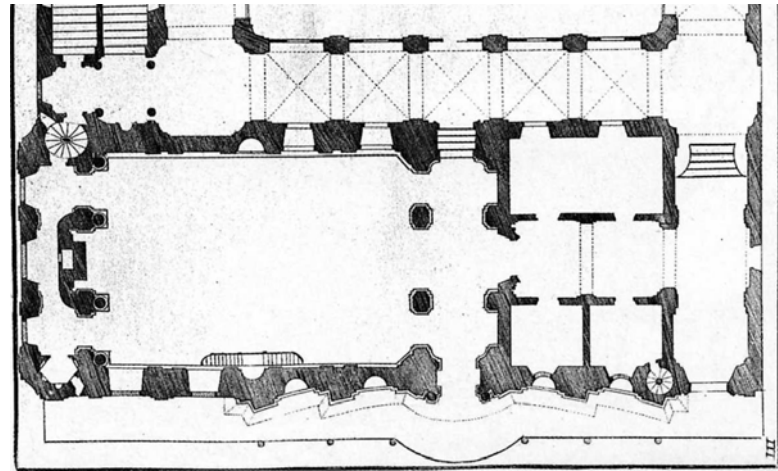
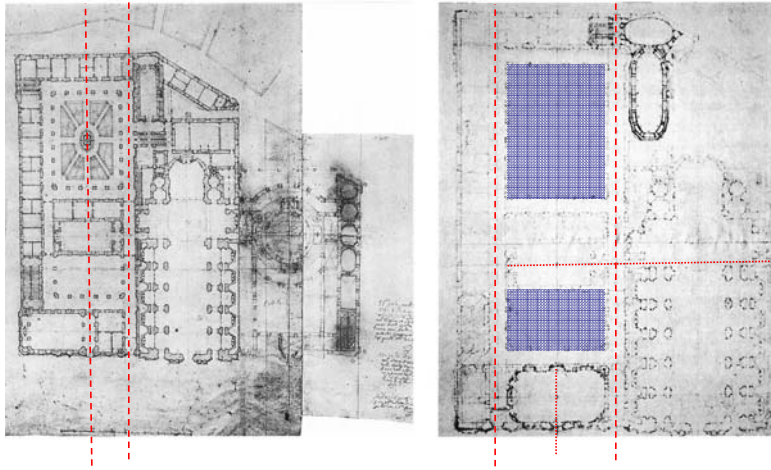

Francesco Borromini,
 pianta dell'oratorio
 e casa dei Filippini
 a Roma, disegno,
 1636-37; nel settore
 a oriente della Chiesa
 Nuova, pianta del più
 tardo progetto,
 non realizzato, per
 la cappella-mausoleo
 dei Pamphili; disegno,
 1636-37 e 1644
 (GSAW, Az Rom 285).

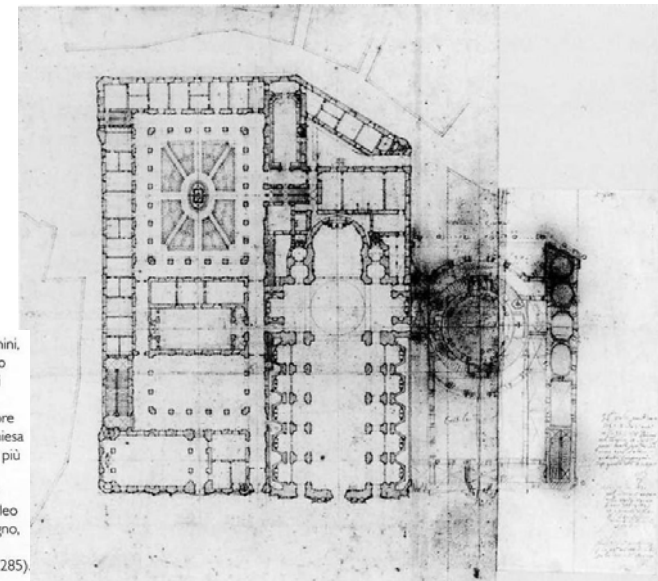

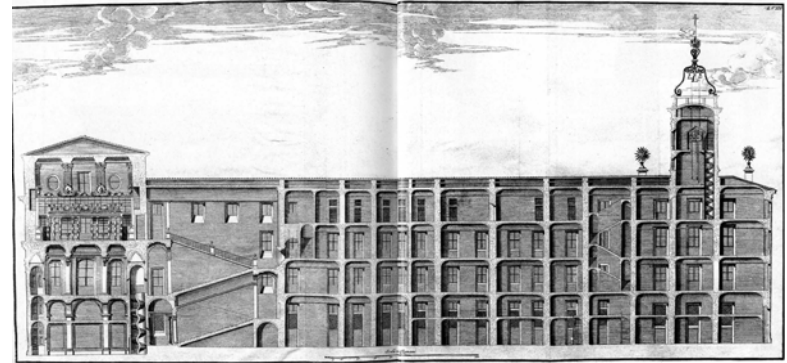

TAV. LVIII

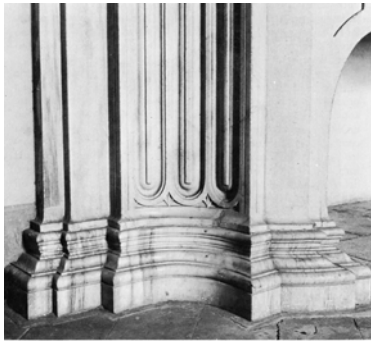

31. Borromini, oratorio di San Filippo Neri, particolare del camino nella sala di ricreazione.

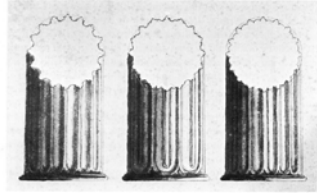

32. G.B. Montano, colonne romane, disegno, particolare.

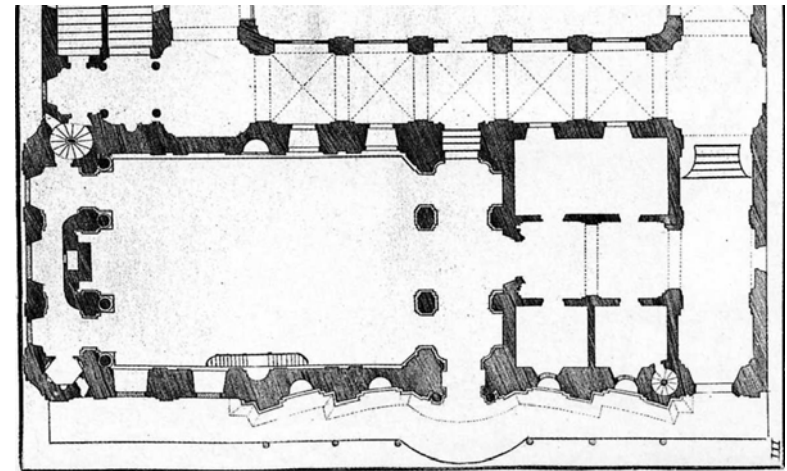

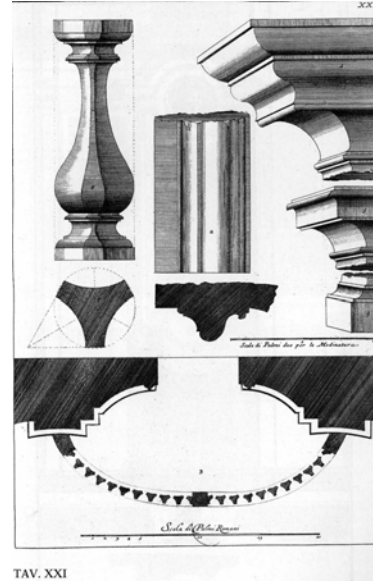

TAV. XXI

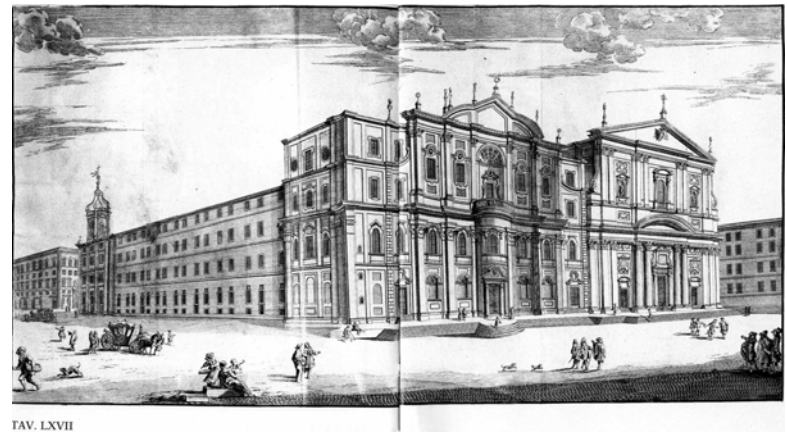

TAV. LXVII



TAV. IV

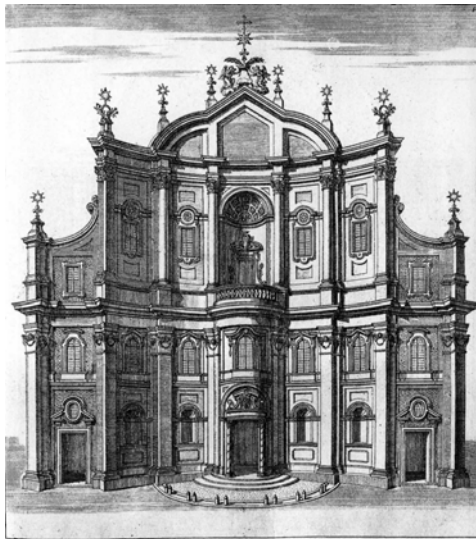

TAV. V



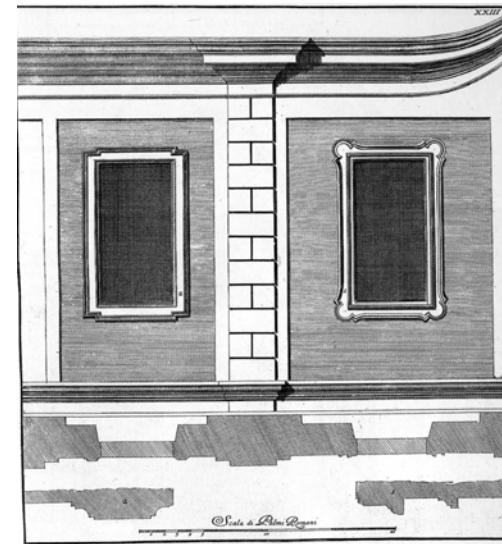
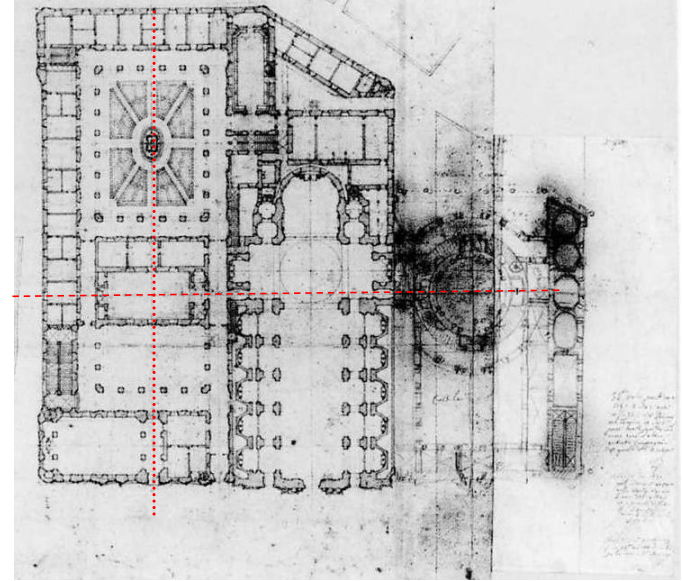
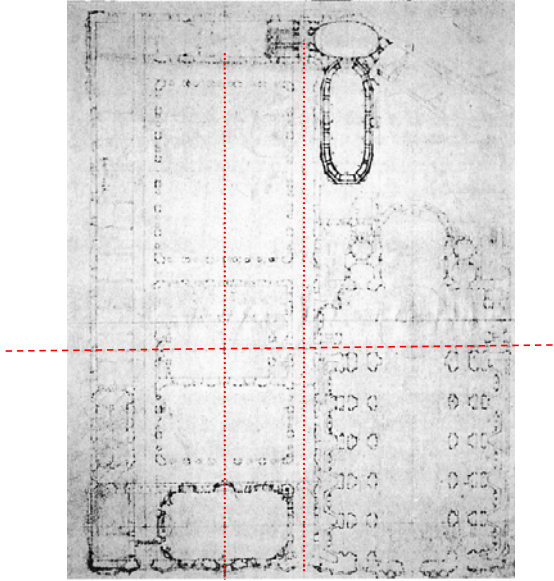

TAV. XXIII

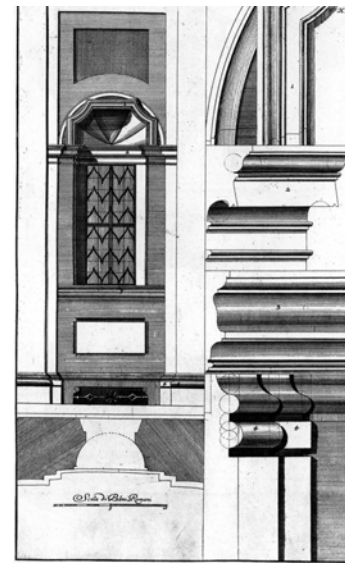
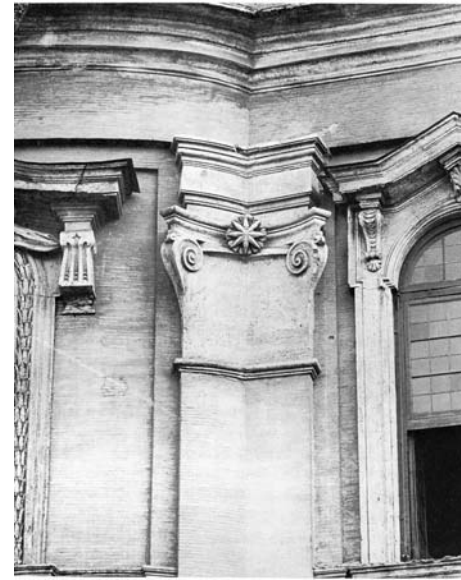

TAV. XII

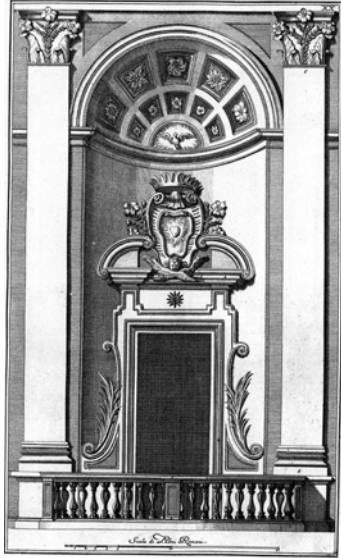

TAV. XX

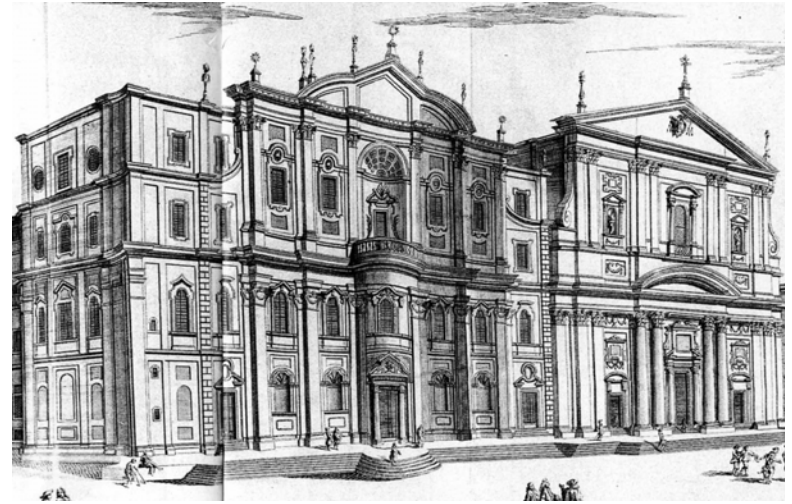

TAV. VI



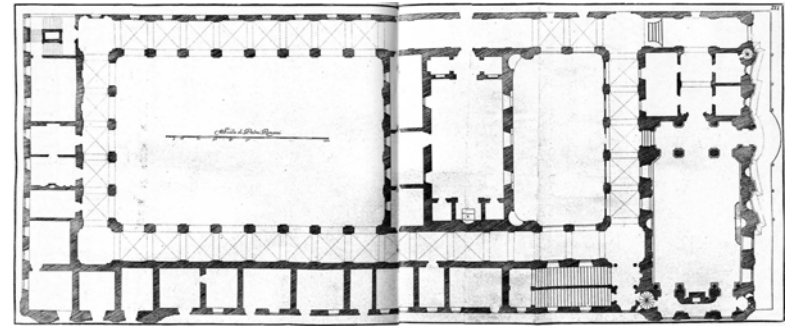
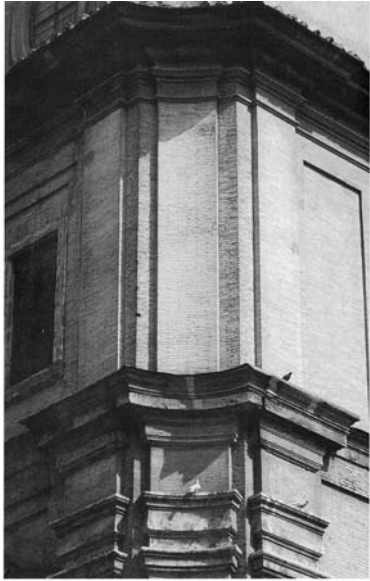

TAV. III

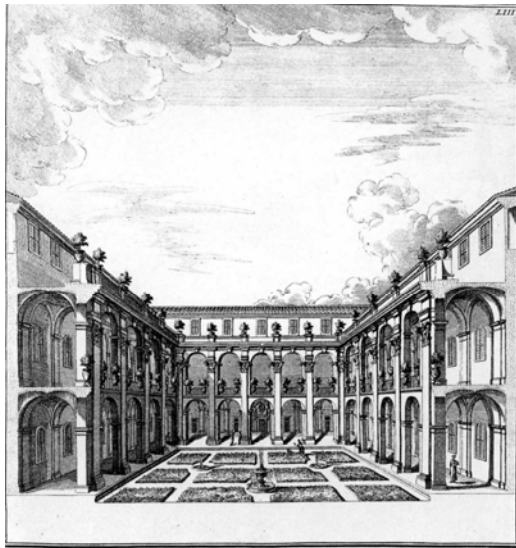

TAV. LIII

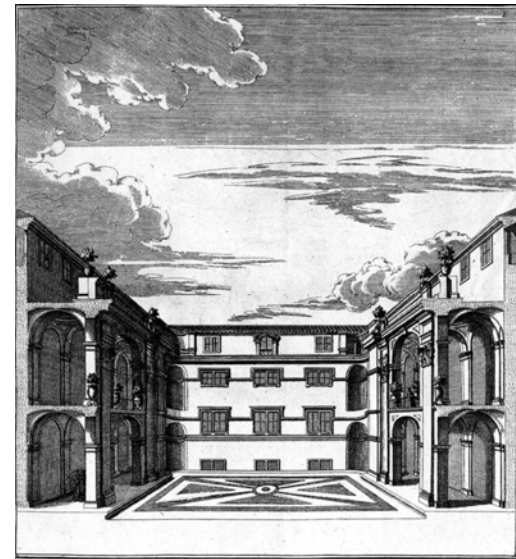

TAV. V

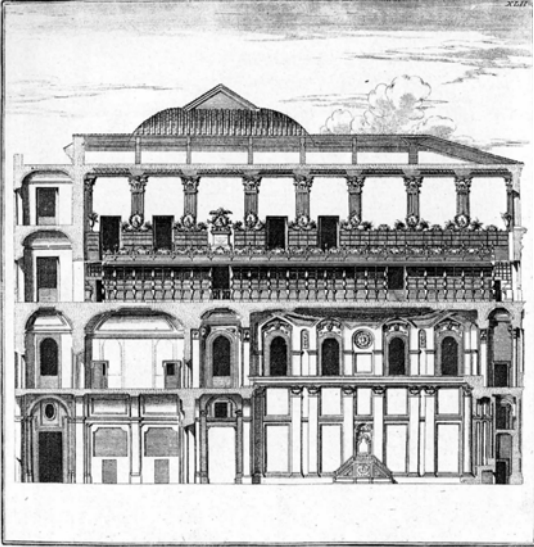

TAV. XI. II

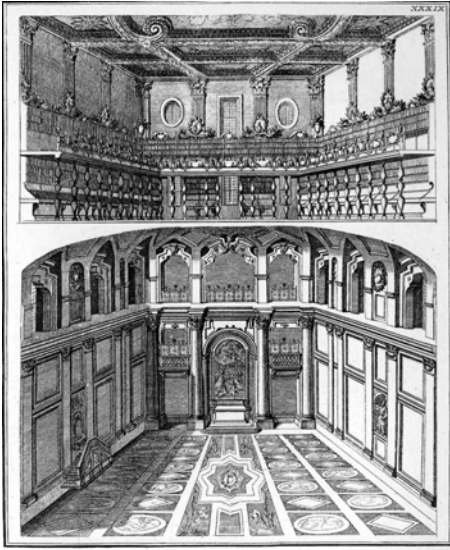

TAV. XXXIX

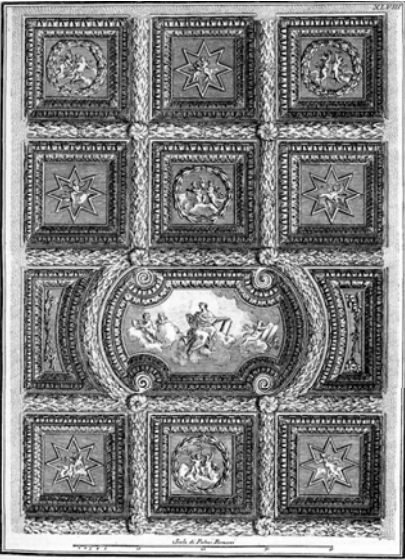

TAV. XLVIII

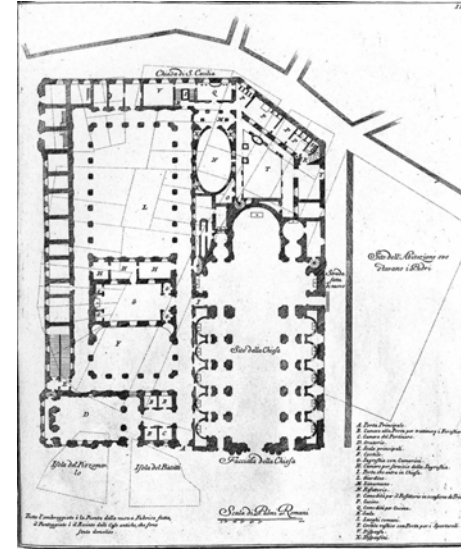
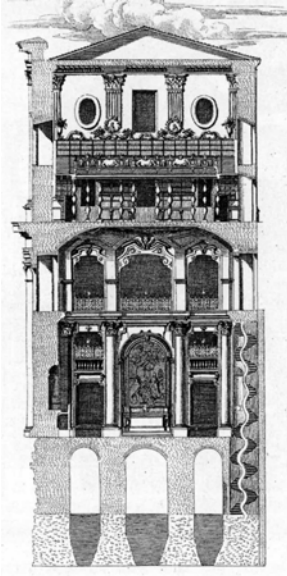

TAV. II

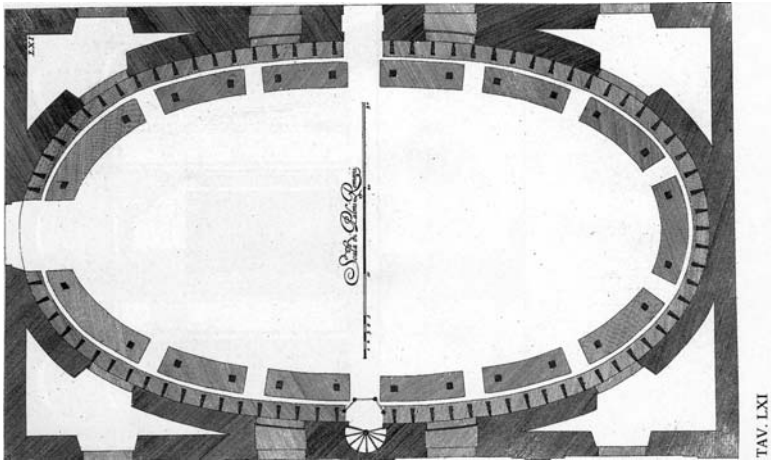

TAV. LXI

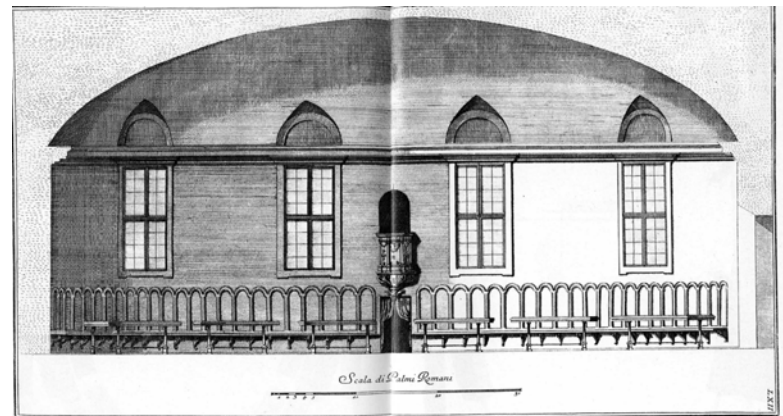

TAV. LXII

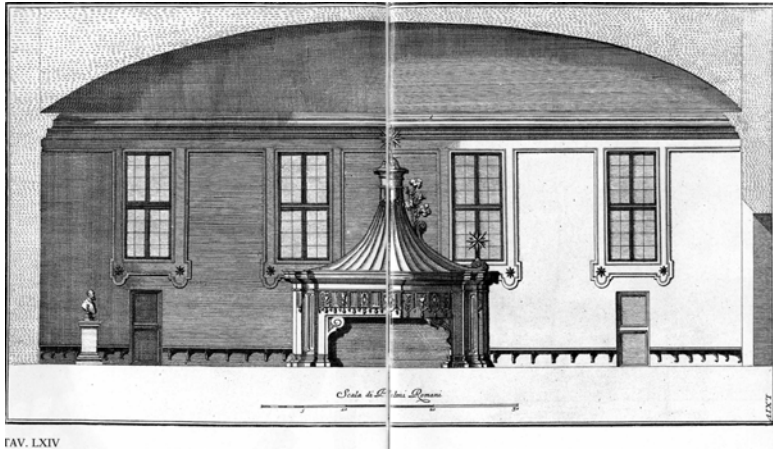

TAV. LXIV

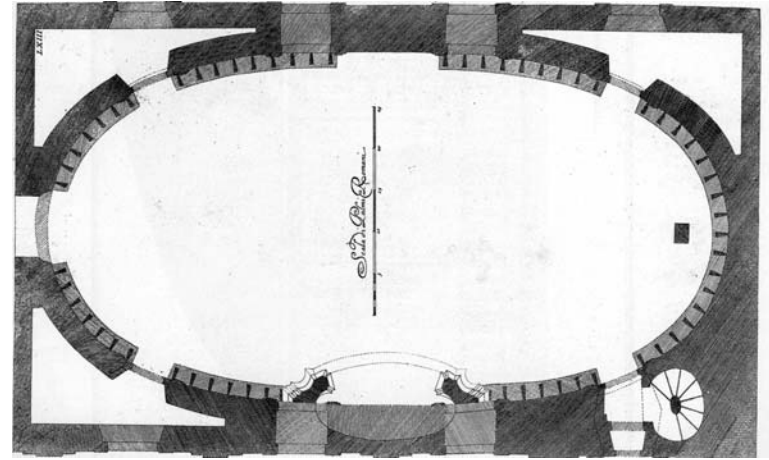

TAV. LXVII

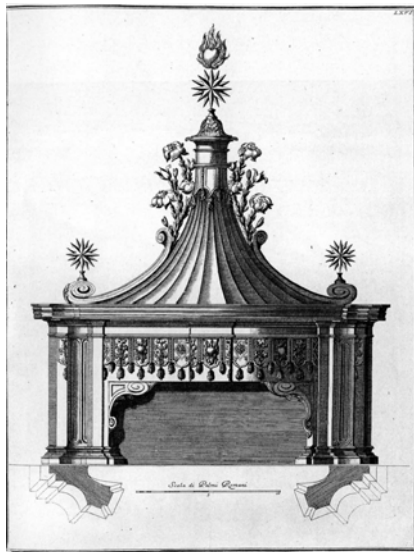

TAV. LXVI

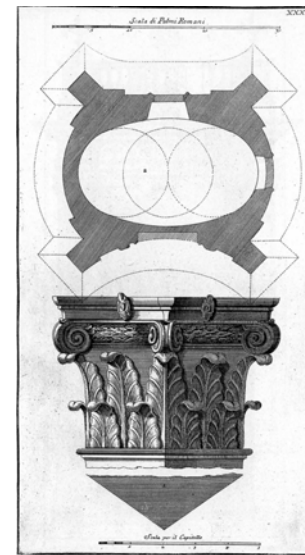

TAV. LXXII

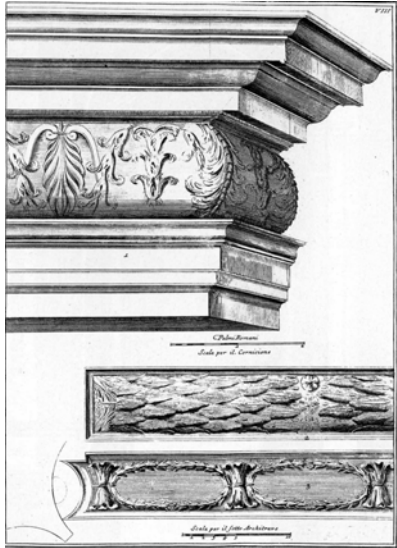

TAV. VIII

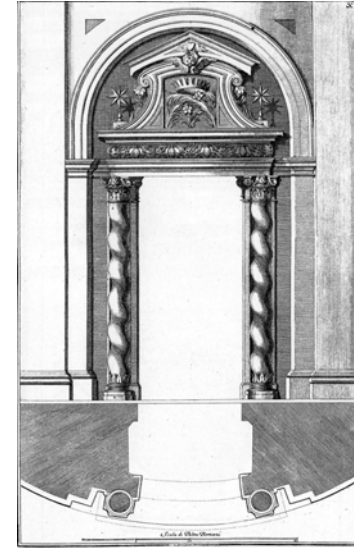

TAV. X

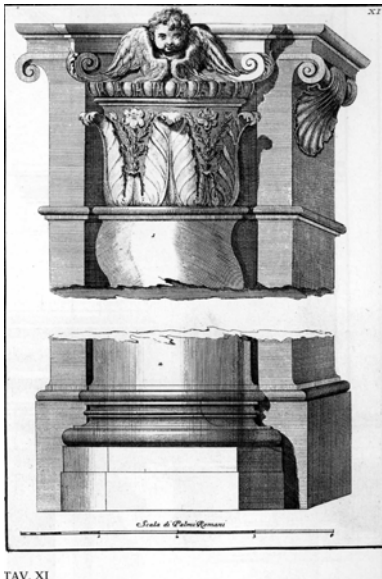

TAV. XI

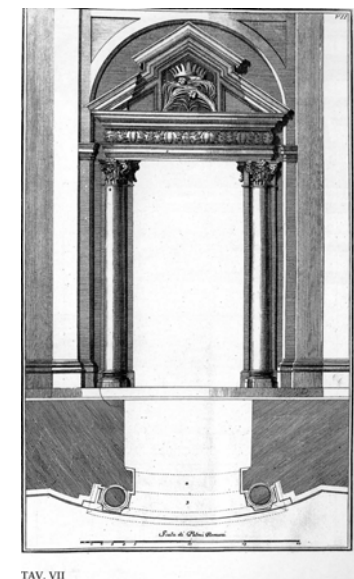

TAV. VII

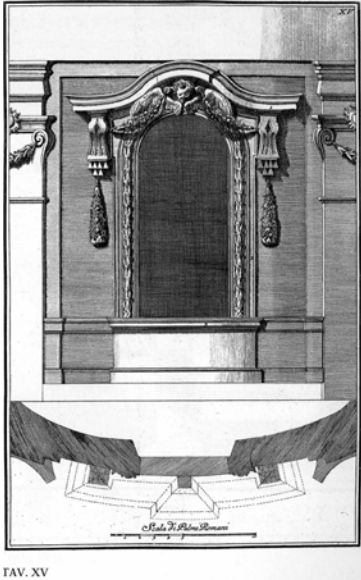

TAV. XV

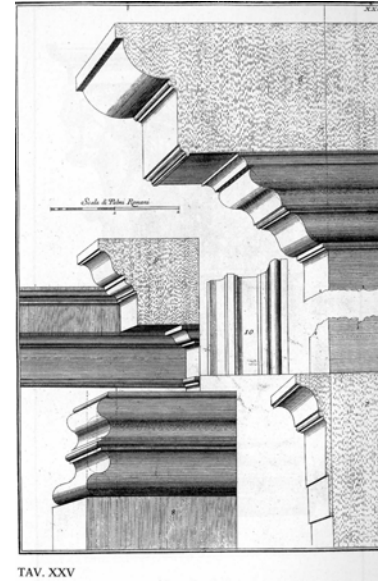

TAV. XXV

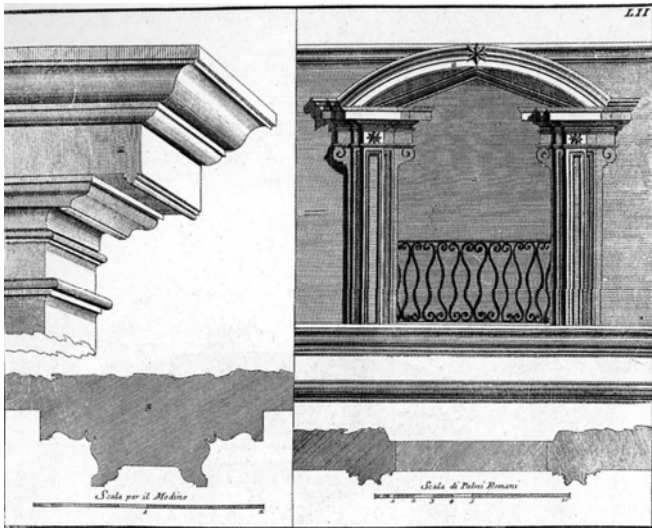

TAV. LII

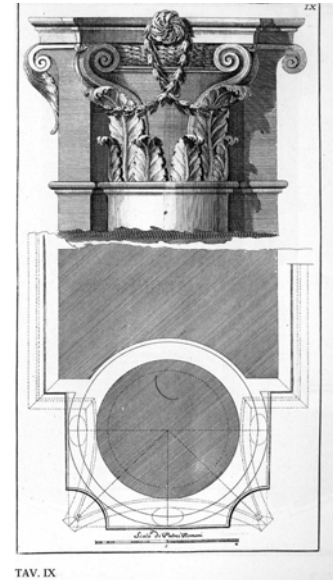

TAV. IX