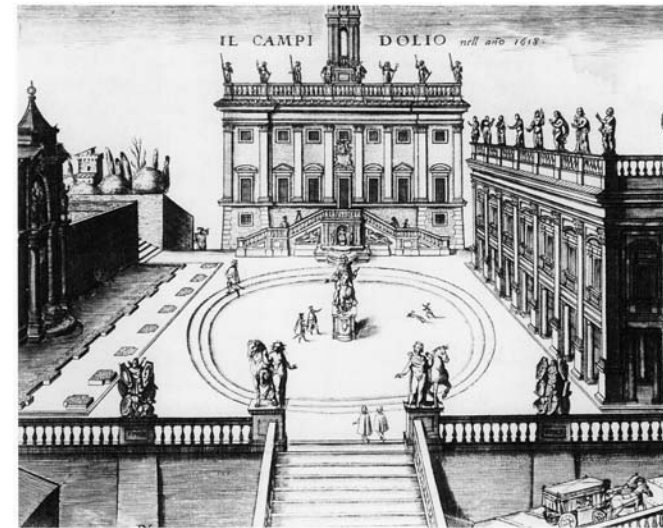
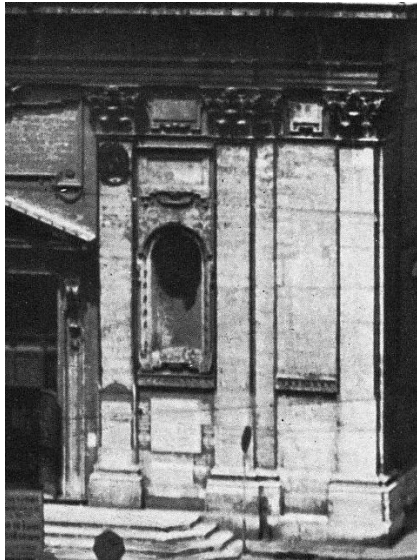
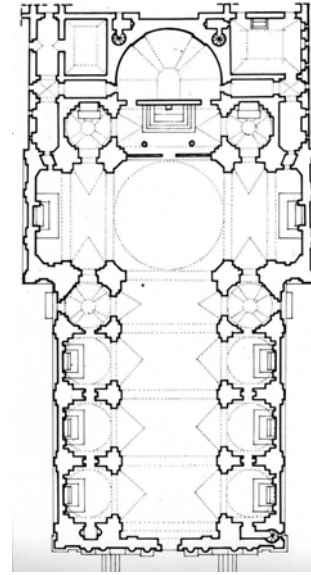
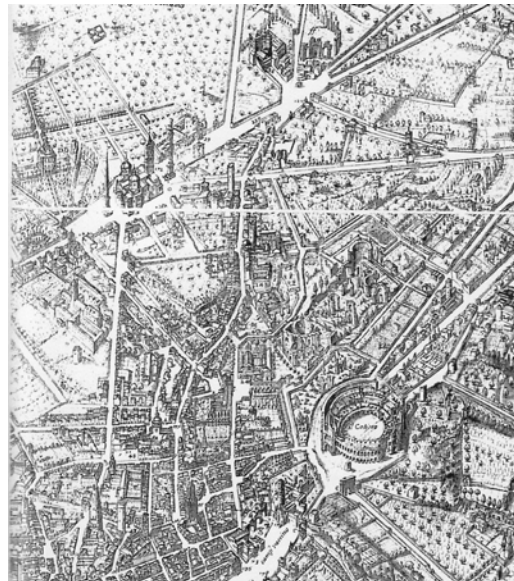
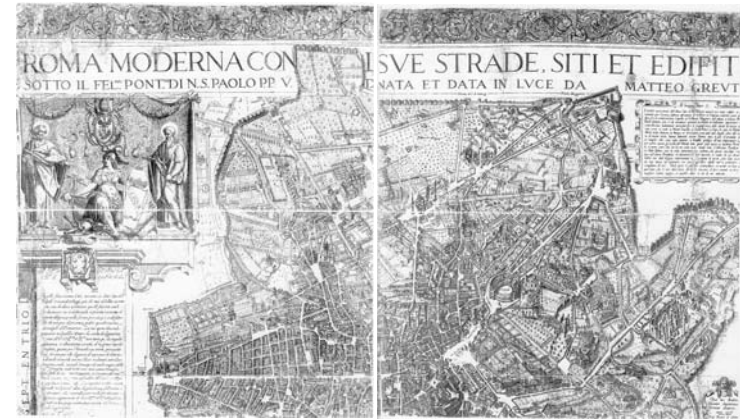


Corso di *Architettura del XVII secolo in Italia*  
5. Paolo V e gli artisti di Scipione Borghese

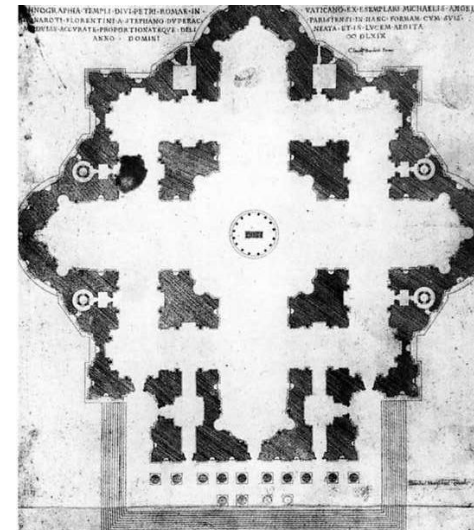
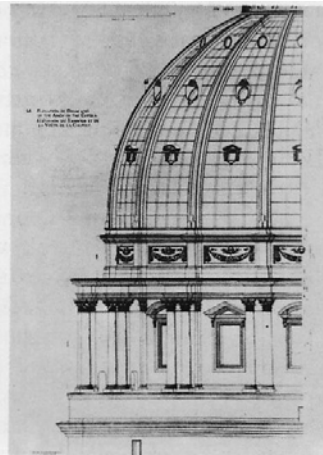
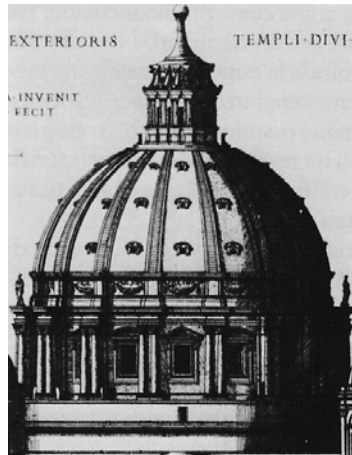
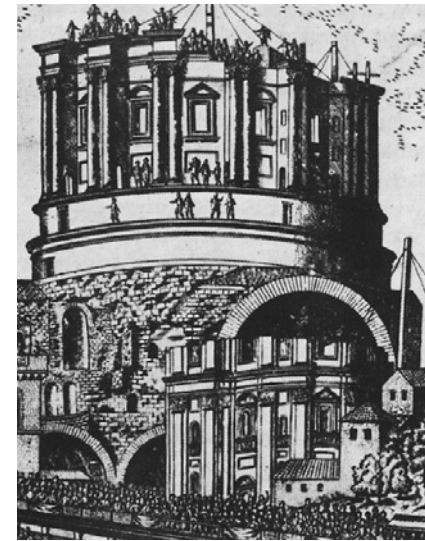






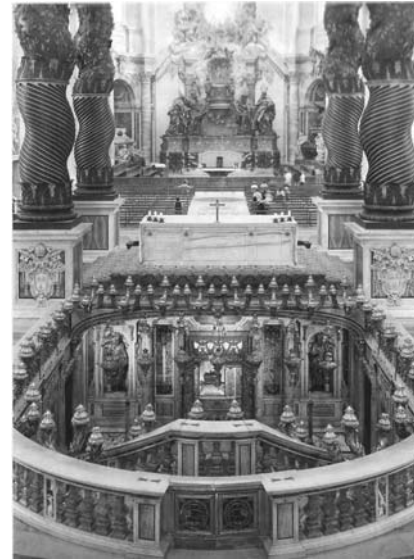
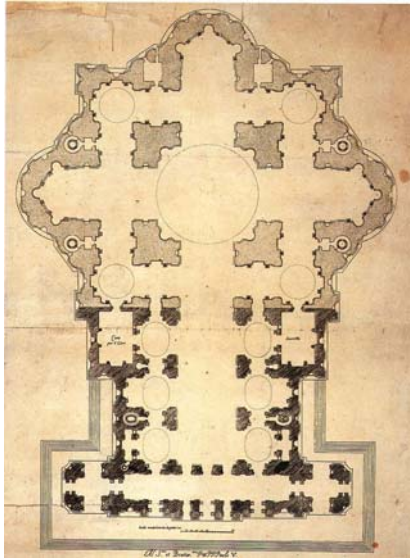


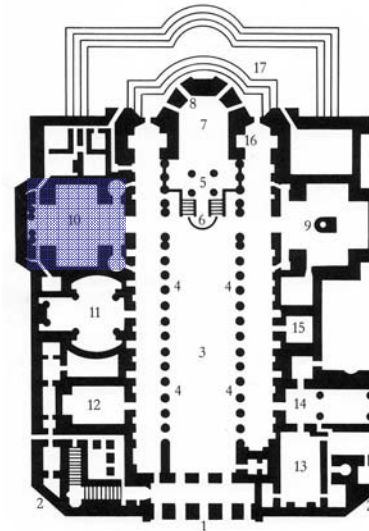
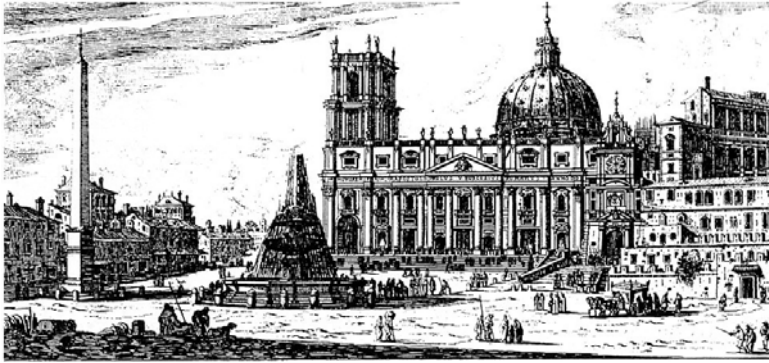
Via baccina



94. S. Dupérac, Esterno della cupola, basato sul progetto di Michelangelo. Incisione.

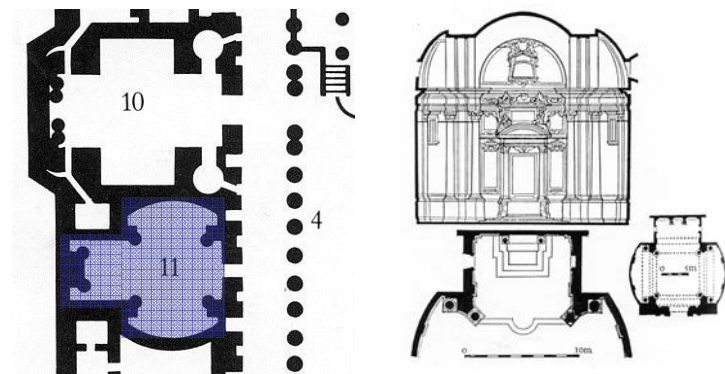
95. P. M. Letarouilly, Esterno della cupola realizzata. Incisione.

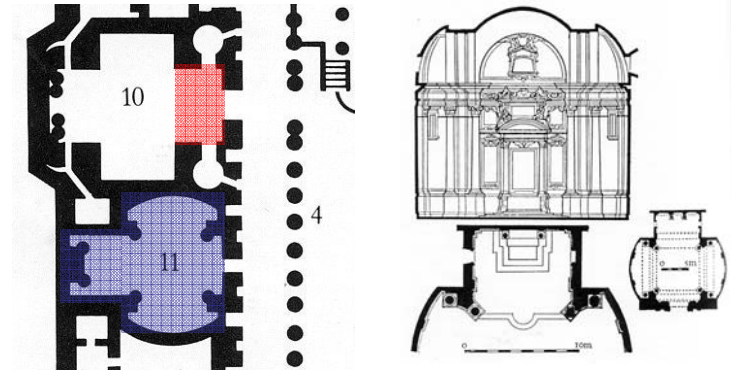




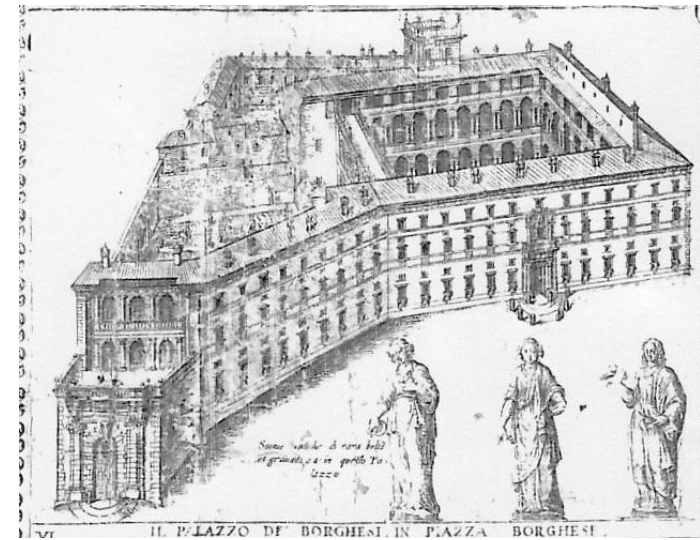
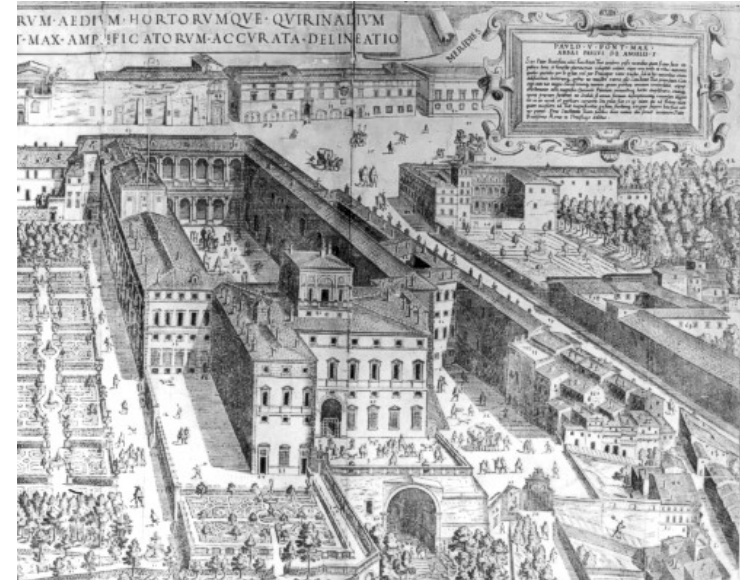
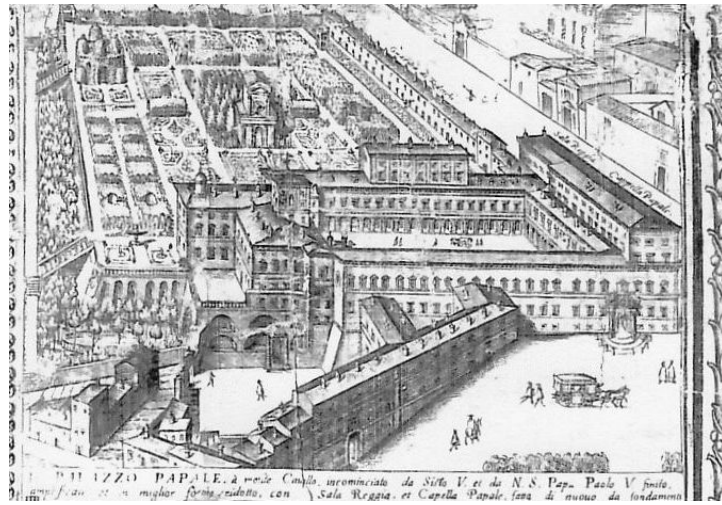
**Santa Maria Maggiore**

- 1 Facciata (1743-50) di F. Fuga.
- 2 Palazzi ecclesiastici gemelli (a sinistra, 1605; a destra, 1743 c.) annessi alla chiesa.
- 3 Navata centrale con soffitto decorato col primo oro mandato dal Nuovo Mondo ad Alessandro VI.
- 4 Mosaici (V secolo) con scene dal Vecchio Testamento sui due lati della navata centrale.
- 5 Altar maggiore col baldacchino del Fuga.
- 6 Confessio con le reliquie di san Matteo e altri santi; di fronte, statua di Pio IX in ginocchio.
- 7 Abside coi mosaici raffiguranti il *Trionfo della Madre del Redentore* (1295) di Jacopo Torriti.
- 8 Finestre gotiche.
- 9 Cappella Sistina (1585) di Domenico Fontana, con la tomba di Sisto V e l'Oratorio del Presepio (c. 1289).
- 10 Cappella Paolina o Borghese (1611) di Flaminio Ponzio, con la tomba di Paolo V.
- 11 Cappella Storza (1564) di G. Della Porta, forse su progetto di Michelangelo.
- 12 Cappella Cesi (c. 1550) di Guidetto Guidetti.
- 13 Sacristia (1605) di Flaminio Ponzio.
- 14 Battistero di Flaminio Ponzio.
- 15 Cappella delle Reliquie (1750) del Fuga.
- 16 Tomba del Bernini e tomba del cardinale G. Rodriguez (m. 1299) di Giovanni di Cosma.
- 17 Scalinata sul retro dell'abside (1673) di C. Rainaldi.

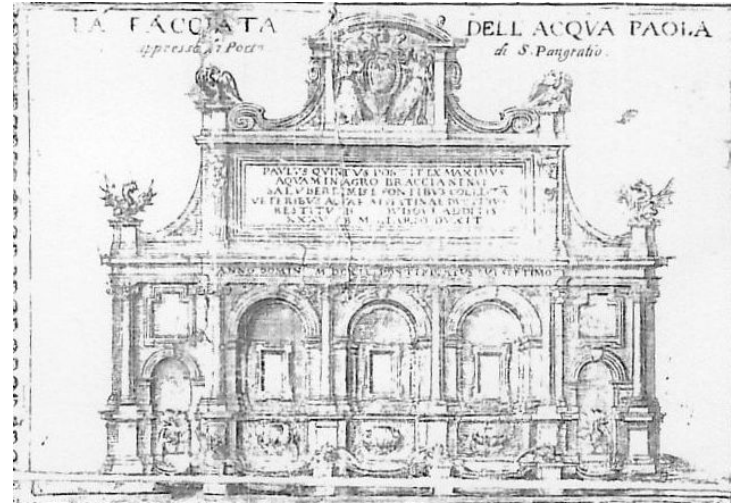
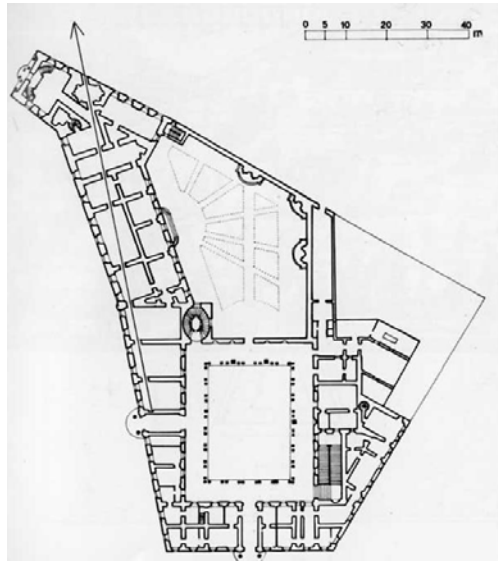












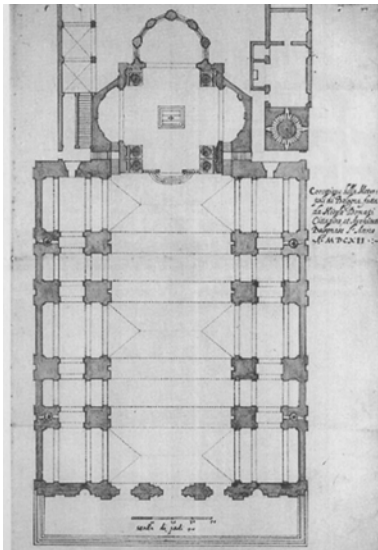


Fig. 92 - N. DONATI (e G. A. MAGENTA): progetto per la ricostruzione della cattedrale di S. Pietro a Bologna, pianta.



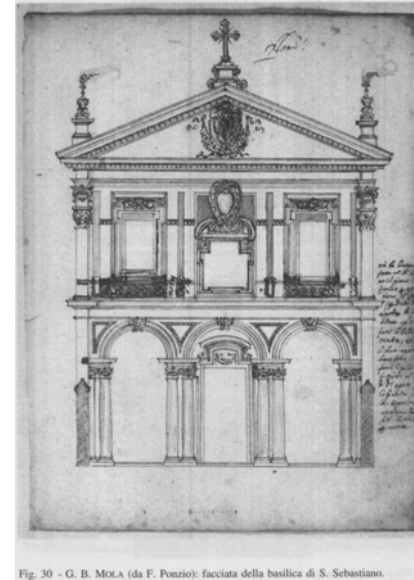
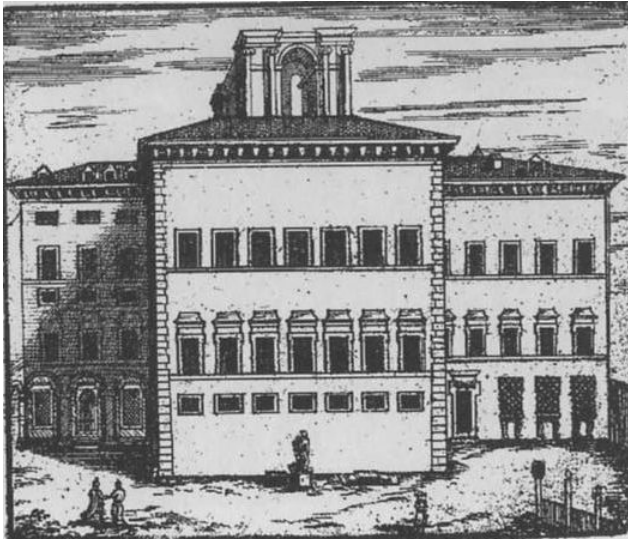
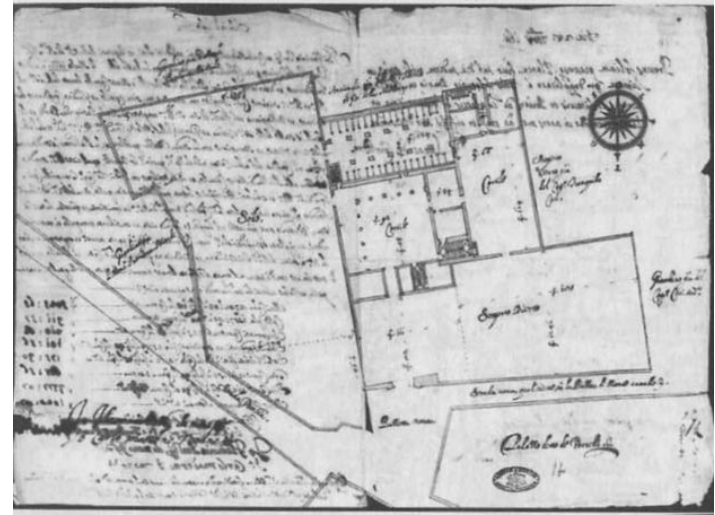
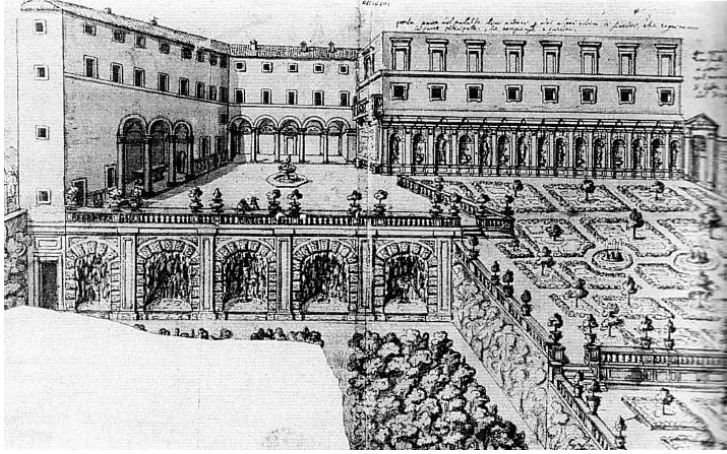
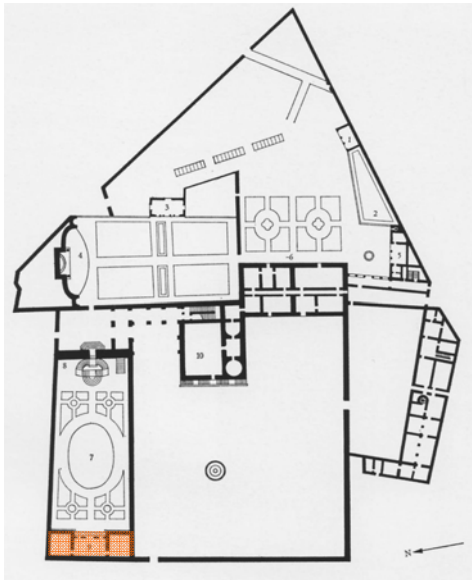
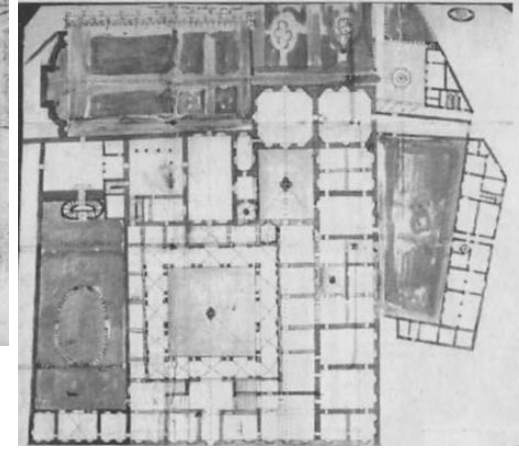
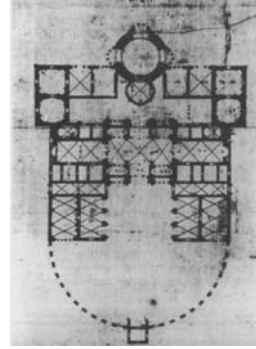
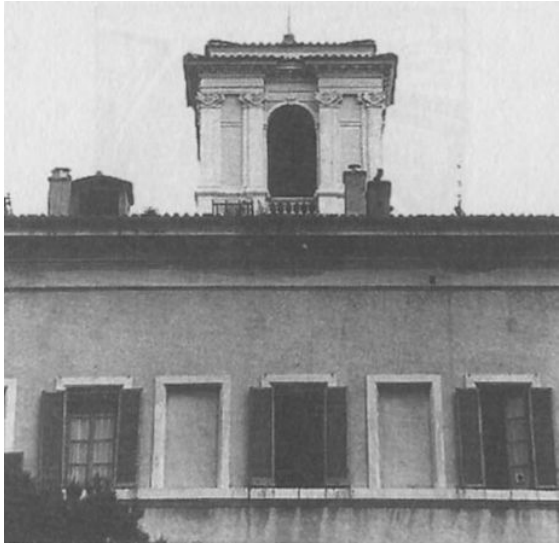


Fig. 30 - G. B. MOLA (da F. Pozzini): facciata della basilica di S. Sebastiano.







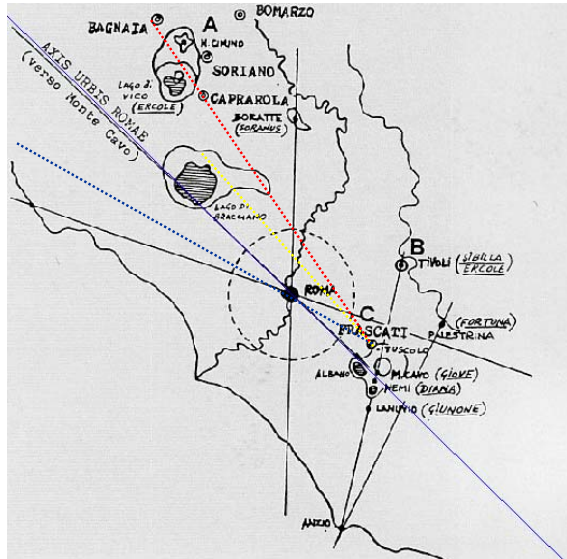
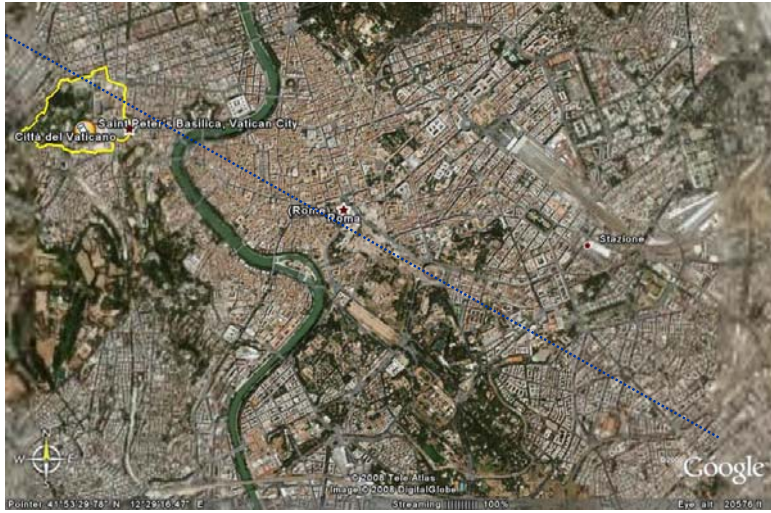


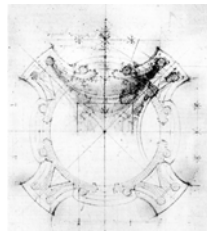
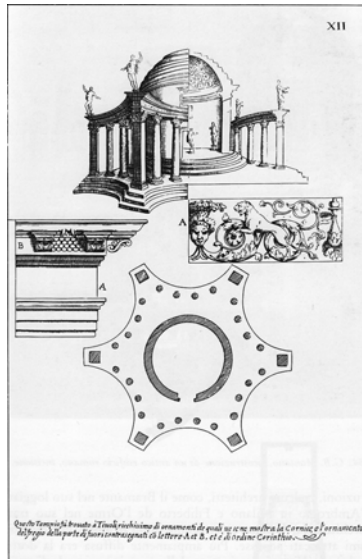
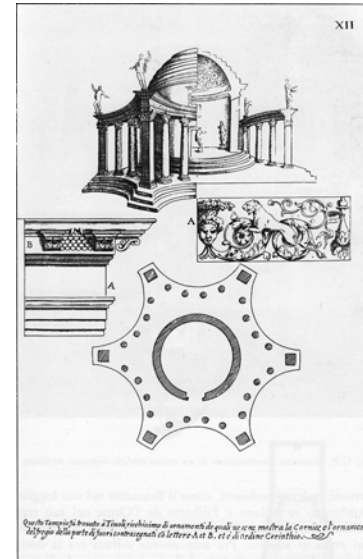
- 1 Casino di Psiche
- 2 Fontana della Grotta
- 3 Casino delle Muse
- 4 Teatro d'acqua
- 5 Casino Biondo
- 6 Fontana a parete
- 7 Peschiera, giardino pensile
- 8 Scala al giardino pensile
- 9 Casino dell'Aurora
- 10 Palazzo

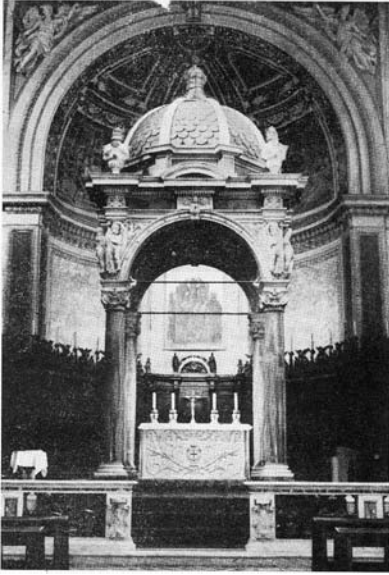




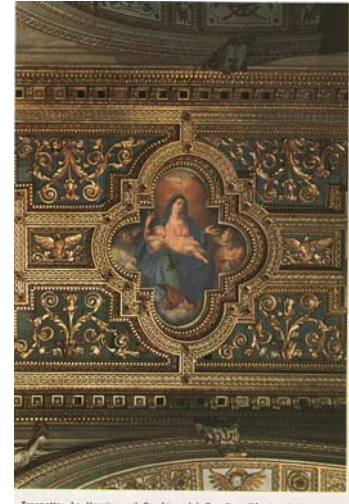








Soffitto: Trionfo di S. Crisostomo (copia di un dipinto del Guercino).



Transetto: La Vergine col Bambino del Cavalier d'Arpino (1560-1640).



«Veduta del Castello dell'Acqua Felice»  
di Pietro Buonamici, in: *Architettura del Rinascimento*, Roma, 1980, p. 100.



